

Source: SIEMENS



Solutions for shipbuilding and offshore



Strong product range, first-class quality

Electrical systems installed on ships often have to meet special requirements – This applies especially for electrical installations. The comprehensive and ISO 9001 quality tested OBO product range assures safe solutions for the most diverse requirements. All marine cable trays and cable ladders for shipbuilding meet the specifications of DIN EN 61537 “Cable management – Cable tray systems and cable ladder systems”, and take into account the building regulations of Germanischer Lloyd and the IEC. In addition, the OBO cable ladders are certified by DNV-GL and RINA. In the field of fire sealings OBO has a system with the fire resistance class A60, with excellent properties certified by Germanischer Lloyd.

Fire sealings
see page 62

Cable tray systems
see page 6



Mounting systems
see page 52

Tightening straps
see page 56

Cable ladder systems
see page 14

Cable tray systems

Selected materials

Whether stainless steel or aluminium, strip-galvanised or hot-dip galvanised: Thanks to the high-quality materials and their optimal processing the OBO cable trays easily meet the high corrosion requirements for shipbuilding.

FS

FT

A2

A4

ALU

Coherent system accessories

Fastening straps on rolls or in pre-fabricated lengths and tightening tools allow an easy, quick and safe installation.



Cable tray MKR...

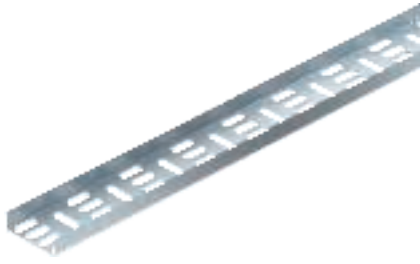

| Width in mm | Plate thickness in mm | FS Strip-galvanised | FT Hot-dip galvanised | A2 Stainless steel | A4 Stainless steel | Alu * |
|-------------|-----------------------|---------------------|-----------------------|--------------------|--------------------|-------|
| 50 | 1.00 | ✓ | ● | ● | ● | ● |
| 75 | 1.00 | ✓ | ● | ● | ● | ● |
| 100 | 1.00 | ✓ | ● | ● | ● | ● |
| 150 | 1.00 | ✓ | ● | ● | ● | ● |
| 200 | 1.00 | ✓ | ● | ● | ● | ● |
| 300 | 1.00 | ✓ | ● | ● | ● | ● |
| 50 | 1.25 | ✓ | ✓ | ✓ | ✓ | ✓ |
| 75 | 1.25 | ✓ | ✓ | ✓ | ✓ | ✓ |
| 100 | 1.25 | ✓ | ✓ | ✓ | ✓ | ✓ |
| 125 | 1.25 | ✓ | ✓ | ✓ | ✓ | ✓ |
| 150 | 1.25 | ✓ | ✓ | ✓ | ✓ | ✓ |
| 200 | 1.25 | ✓ | ✓ | ✓ | ✓ | ✓ |
| 250 | 1.25 | ✓ | ✓ | ✓ | ✓ | ✓ |
| 300 | 1.25 | ✓ | ✓ | ✓ | ✓ | ✓ |

* Deviating plate thickness

● on request

Straight connector MKR SV...



| FS Strip-galvanised | FT Hot-dip galvanised | A2 Stainless steel | A4 Stainless steel | Alu |
|---------------------|-----------------------|--------------------|--------------------|-----|
| ✓ | ✓ | ✓ | ✓ | ✓ |

90° bend MKRB 90...



| Width in mm | Plate thickness in mm | FS Strip-galvanised | FT Hot-dip galvanised | A2 Stainless steel | A4 Stainless steel | Alu * |
|-------------|-----------------------|---------------------|-----------------------|--------------------|--------------------|-------|
| 50 | 1.25 | ✓ | ✓ | ● | ● | ● |
| 75 | 1.25 | ✓ | ✓ | ● | ● | ● |
| 100 | 1.25 | ✓ | ✓ | ● | ● | ● |
| 125 | 1.25 | ✓ | ✓ | ● | ● | ● |
| 150 | 1.25 | ✓ | ✓ | ● | ● | ● |
| 200 | 1.25 | ✓ | ✓ | ● | ● | ● |
| 250 | 1.25 | ✓ | ✓ | ● | ● | ● |
| 300 | 1.25 | ✓ | ✓ | ● | ● | ● |

* Deviating plate thickness

● on request

Cable tray, marine standard

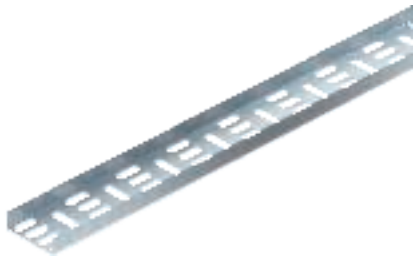

| Type | Width mm | Plate thickness mm | Pack. m | Weight kg/100 m | Item No. |
|----------------------|-------------|--------------------------|------------|--------------------|------------------|
| | | | | | |
| MKR 15 075 FS | 75 | 1 | 2 | 64,000 | 6045 96 0 |
| MKR 15 100 FS | 100 | 1 | 2 | 76,000 | 6045 97 9 |
| MKR 15 150 FS | 150 | 1 | 2 | 104,000 | 6045 99 5 |
| MKR 15 200 FS | 200 | 1 | 2 | 131,000 | 6046 00 2 |

St Steel

FS Strip-galvanised

/m

Cable tray according to marine standard.

Dimensions

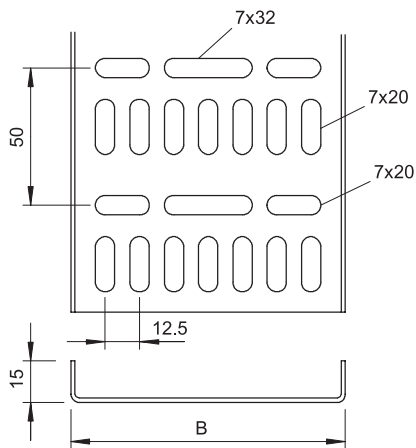

| Type | Length mm | Dimen- sion B mm | Side height mm |
|----------------------|--------------|------------------------|----------------------|
| | | | |
| MKR 15 075 FS | 2000 | 75 | 15 |
| MKR 15 100 FS | 2000 | 100 | 15 |
| MKR 15 150 FS | 2000 | 150 | 15 |
| MKR 15 200 FS | 2000 | 200 | 15 |

Straight connector



| Type | Pack. pcs | Weight kg/100 pcs. | Item No. |
|------|--------------|-----------------------|----------|
| | | | |

St Steel

FS Strip-galvanised

/pc.

Straight connector for marine cable tray with a side height of 15 mm.

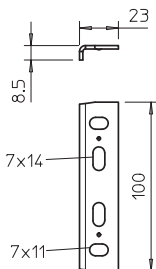

Cable tray, marine standard

| Type | Width mm | Plate thickness mm | Pack. m | Weight kg/100 m | Item No. |
|----------------------|-------------|--------------------------|------------|--------------------|------------------|
| | | | | | |
| MKR 15 075 FS | 75 | 1.25 | 2 | 78,500 | 6046 37 2 |
| MKR 15 100 FS | 100 | 1.25 | 2 | 97,000 | 6046 37 4 |
| MKR 15 125 FS | 125 | 1.25 | 2 | 113,400 | 6046 37 5 |
| MKR 15 150 FS | 150 | 1.5 | 2 | 135,500 | 6046 37 6 |
| MKR 15 200 FS | 200 | 1.5 | 2 | 194,500 | 6046 00 4 |
| MKR 15 250 FS | 250 | 1.5 | 2 | 235,250 | 6046 37 9 |
| MKR 15 300 FS | 300 | 1.5 | 2 | 275,000 | 6046 02 9 |
| MKR 15 050 FT | 50 | 1.25 | 2 | 65,500 | 6045 05 7 |
| MKR 15 075 FT | 75 | 1.25 | 2 | 84,700 | 6045 07 3 |
| MKR 15 100 FT | 100 | 1.25 | 2 | 104,000 | 6045 10 3 |
| MKR 15 125 FT | 125 | 1.25 | 2 | 125,500 | 6045 13 8 |
| MKR 15 150 FT | 150 | 1.5 | 2 | 162,500 | 6045 15 4 |
| MKR 15 200 FT | 200 | 1.5 | 2 | 205,500 | 6045 20 0 |
| MKR 15 250 FT | 250 | 1.5 | 2 | 253,000 | 6045 25 1 |
| MKR 15 300 FT | 300 | 1.5 | 2 | 292,700 | 6045 30 8 |

St Steel

FS Strip-galvanised **FT** Hot-dip galvanised

Cable tray according to marine standard.

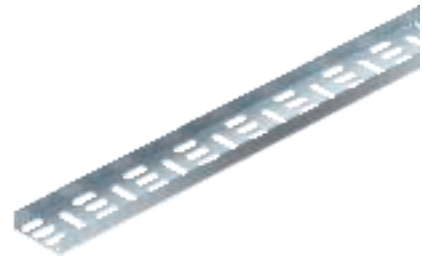

| Type | Length mm | Dimen- sion B mm | Side height mm |
|----------------------|--------------|------------------------|----------------------|
| | | | |
| MKR 15 075 FS | 2000 | 75 | 15 |
| MKR 15 100 FS | 2000 | 100 | 15 |
| MKR 15 125 FS | 2000 | 125 | 15 |
| MKR 15 150 FS | 2000 | 150 | 15 |
| MKR 15 200 FS | 2000 | 200 | 15 |
| MKR 15 250 FS | 2000 | 250 | 15 |
| MKR 15 300 FS | 2000 | 300 | 15 |

Dimensions

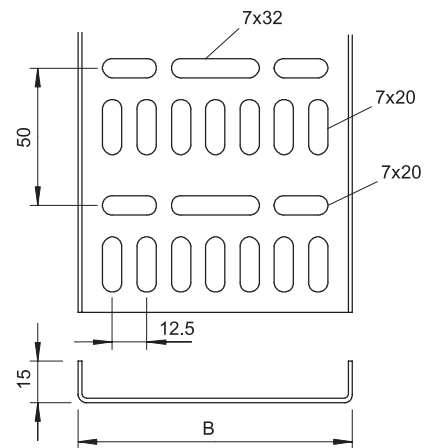

Straight connector

| Type | Pack. pcs | Weight kg/100 pcs. | Item No. |
|------------------|--------------|-----------------------|------------------|
| | | | |
| MKR SV FT | 25 | 5,000 | 6066 24 0 |

St Steel

FS Strip-galvanised **FT** Hot-dip galvanised

Straight connector for marine cable tray with a side height of 15 mm.

/pc.

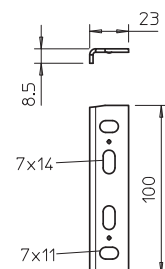

Straight connector



| Type | Pack. pcs | Weight kg/100 pcs. | Item No. |
|------------------|-----------|--------------------|------------------|
| MKR KV FT | 25 | 8,800 | 6066 14 3 |

St Steel /pc.

FT Hot-dip galvanised

Straight connector for marine cable tray with a side height of 15 mm.

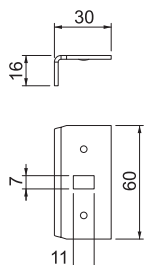

90° bend



| Type | Width mm | Plate thickness mm | Pack. pcs | Weight kg/100 pcs. | Item No. |
|-------------------------|----------|--------------------|-----------|--------------------|------------------|
| MKRB 90 15 050FS | 51 | 1.25 | 1 | 14,600 | 7061 14 6 |
| MKRB 90 15 075FS | 76 | 1.25 | 1 | 21,300 | 7061 05 0 |
| MKRB 90 15 100FS | 101 | 1.25 | 1 | 28,400 | 7061 24 4 |
| MKRB 90 15 125FS | 126 | 1.25 | 1 | 56,500 | 7061 25 2 |
| MKRB 90 15 150FS | 151 | 1.5 | 1 | 73,300 | 7061 36 0 |
| MKRB 90 15 200FS | 201 | 1.5 | 1 | 102,400 | 7061 44 9 |
| MKRB 90 15 250FS | 252 | 1.5 | 1 | 163,800 | 7061 54 6 |
| MKRB 90 15 300FS | 302 | 1.5 | 1 | 206,000 | 7061 64 3 |

| | | | | | |
|-------------------------|-----|------|---|---------|------------------|
| MKRB 90 15 050FT | 51 | 1.25 | 1 | 16,000 | 7061 14 5 |
| MKRB 90 15 075FT | 76 | 1.25 | 1 | 23,280 | 7061 04 8 |
| MKRB 90 15 100FT | 101 | 1.25 | 1 | 31,090 | 7061 24 2 |
| MKRB 90 15 125FT | 125 | 1.25 | 1 | 61,000 | 7061 25 0 |
| MKRB 90 15 150FT | 151 | 1.5 | 1 | 79,210 | 7061 35 8 |
| MKRB 90 15 200FT | 201 | 1.5 | 1 | 110,600 | 7061 44 7 |
| MKRB 90 15 250FT | 252 | 1.5 | 1 | 176,900 | 7061 54 4 |
| MKRB 90 15 300FT | 302 | 1.5 | 1 | 222,480 | 7061 64 1 |

St Steel /pc.

FS Strip-galvanised **FT** Hot-dip galvanised

90° bend for marine cable tray with a side height of 15 mm.

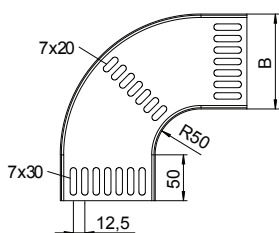

Corner connector

| Type | Pack. pcs | Weight kg/100 pcs. | Item No. |
|------------------|-----------|--------------------|------------------|
| MKR EV FT | 1 | 9,330 | 7060 04 1 |

St Steel /pc.

FT Hot-dip galvanised

Corner connector for marine cable trays according to the marine standard with side height of 15 mm.

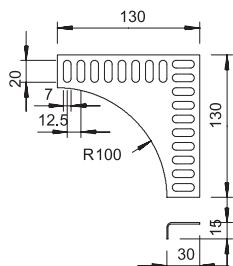

Truss-head bolt with flange nut

| Type | Dimension mm | Dimen- sion L mm | Dimen- sion d mm | Dimen- sion D mm | Pack. pcs | Weight kg/100 pcs. | Item No. |
|--------------------|-----------------|------------------------|------------------------|------------------------|--------------|-----------------------|------------------|
| FRSB 6X12 F | M 6 x 12 | 12 | 6 | 13.5 | 100 | 0,990 | 6406 12 2 |

St Steel
F Hot-dip galvanised

/100 pc.

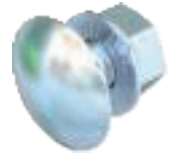
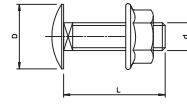

Truss-head bolt with square neck including flange nut.

Cable tray, marine standard

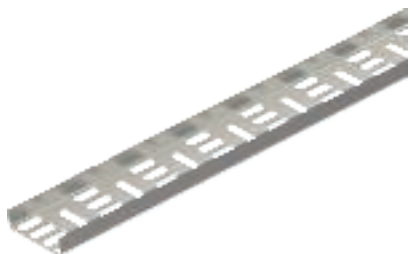

| Type | Width mm | Plate thickness mm | Pack. m | Weight | | Item No. |
|----------------------|-------------|--------------------------|------------|----------|----|------------------|
| | | | | kg/100 m | /m | |
| MKR 15 050 A2 | 50 | 1.25 | 2 | 61,250 | | 6045 83 0 |
| MKR 15 075 A2 | 75 | 1.25 | 2 | 80,000 | | 6045 83 2 |
| MKR 15 100 A2 | 100 | 1.25 | 2 | 95,000 | | 6045 83 4 |
| MKR 15 125 A2 | 125 | 1.25 | 2 | 113,400 | | 6045 83 6 |
| MKR 15 150 A2 | 150 | 1.5 | 2 | 156,000 | | 6045 83 8 |
| MKR 15 200 A2 | 200 | 1.5 | 2 | 196,500 | | 6045 84 0 |
| MKR 15 250 A2 | 250 | 1.5 | 2 | 235,250 | | 6045 84 2 |
| MKR 15 300 A2 | 300 | 1.5 | 2 | 275,000 | | 6045 84 4 |
| MKR 15 050 A4 | 50 | 1.25 | 2 | 49,000 | | 6045 85 0 |
| MKR 15 075 A4 | 75 | 1.25 | 2 | 64,000 | | 6045 85 2 |
| MKR 15 100 A4 | 100 | 1.25 | 2 | 76,000 | | 6045 85 4 |
| MKR 15 125 A4 | 125 | 1.25 | 2 | 90,700 | | 6045 85 6 |
| MKR 15 150 A4 | 150 | 1.5 | 2 | 156,000 | | 6045 85 8 |
| MKR 15 200 A4 | 200 | 1.5 | 2 | 196,500 | | 6045 86 0 |
| MKR 15 250 A4 | 250 | 1.5 | 2 | 235,250 | | 6045 86 2 |
| MKR 15 300 A4 | 300 | 1.5 | 2 | 275,000 | | 6045 86 4 |

V2A Stainless steel, A2 V4A Stainless steel, A4

/m

Cable tray according to marine standard.

Dimensions

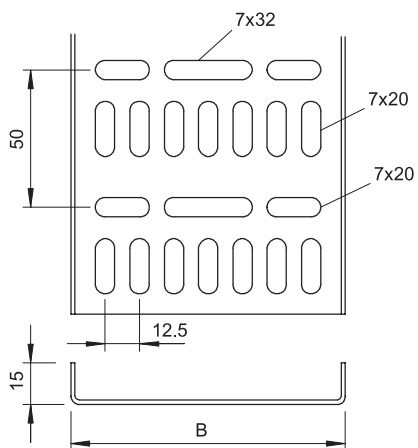

| Type | Length mm | Dimen- sion B | | Side height mm |
|----------------------|--------------|------------------|----|----------------------|
| | | mm | mm | |
| MKR 15 050 A2 | 2000 | 50 | 15 | |
| MKR 15 075 A2 | 2000 | 75 | 15 | |
| MKR 15 100 A2 | 2000 | 100 | 15 | |
| MKR 15 125 A2 | 2000 | 125 | 15 | |
| MKR 15 150 A2 | 2000 | 150 | 15 | |
| MKR 15 200 A2 | 2000 | 200 | 15 | |
| MKR 15 250 A2 | 2000 | 250 | 15 | |
| MKR 15 300 A2 | 2000 | 300 | 15 | |

Straight connector



| Type | Pack. pcs | Weight | | Item No. |
|------------------|--------------|-------------|------|------------------|
| | | kg/100 pcs. | /pc. | |
| MKR SV A2 | 25 | 5,485 | | 6066 24 4 |
| MKR SV A4 | 25 | 5,485 | | 6066 24 6 |

V2A Stainless steel, A2 V4A Stainless steel, A4

/pc.

Straight connector for marine cable tray with a side height of 15 mm.

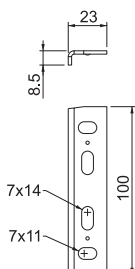

Cable tray, marine standard

| Type | Width mm | Plate thickness mm | Pack. m | Weight kg/100 m | Item No. |
|-----------------------|-------------|--------------------------|------------|--------------------|------------------|
| MKR 15 050 ALU | 50 | 1.5 | 2 | 25,500 | 6045 70 7 |
| MKR 15 075 ALU | 75 | 1.5 | 2 | 33,000 | 6045 71 5 |
| MKR 15 100 ALU | 100 | 1.5 | 2 | 39,500 | 6045 72 3 |
| MKR 15 125 ALU | 125 | 1.5 | 2 | 46,800 | 6045 73 1 |
| MKR 15 150 ALU | 150 | 1.5 | 2 | 70,500 | 6045 75 8 |
| MKR 15 200 ALU | 200 | 2 | 2 | 89,500 | 6045 76 6 |
| MKR 15 250 ALU | 250 | 2 | 2 | 107,900 | 6045 77 4 |
| MKR 15 300 ALU | 300 | 2 | 2 | 126,500 | 6045 78 2 |

Alu Aluminium

/m

Cable tray according to marine standard.



| Type | Length mm | Dimen- sion B mm | Side height mm |
|-----------------------|--------------|------------------------|----------------------|
| MKR 15 050 ALU | 2000 | 50 | 15 |
| MKR 15 075 ALU | 2000 | 75 | 15 |
| MKR 15 100 ALU | 2000 | 100 | 15 |
| MKR 15 125 ALU | 2000 | 125 | 15 |
| MKR 15 150 ALU | 2000 | 150 | 15 |
| MKR 15 200 ALU | 2000 | 200 | 15 |
| MKR 15 250 ALU | 2000 | 250 | 15 |
| MKR 15 300 ALU | 2000 | 300 | 15 |

Dimensions

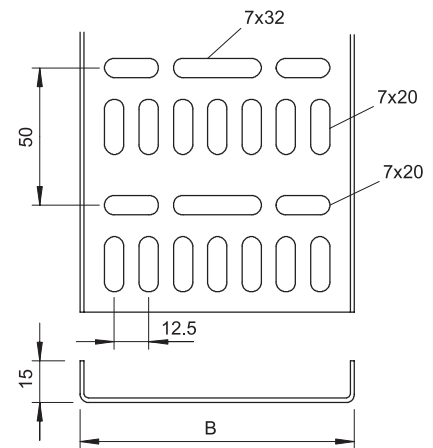

Straight connector

| Type | Pack. pcs | Weight kg/100 pcs. | Item No. |
|-------------------|--------------|-----------------------|------------------|
| MKR SV ALU | 25 | 2,910 | 6066 24 8 |

Alu Aluminium

/pc.

Straight connector for marine cable tray with a side height of 15 mm.

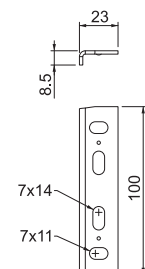

Cable ladder systems



Exact processing

The OBO cable ladders are characterized by a burr-free perforation and high-precision welds made with automated manufacturing. The low weight is achieved by the side rail punching and brings advantages for assembly and transport. The OBO cable ladders are available with types of rungs: in trapezoidal shape or Z-shape for two-sided cable routing. A straight connection is also possible when the cable ladders get cut.



SG

FT

A2

A4

ALU

Materials for highest requirements

By using the SIGMA-WELD 199 welding primer the OBO cable ladders reach an extremely high corrosion resistance. They are only manufactured of highest quality materials: stainless steel or aluminum, welding primed or hot-dip galvanized.



Coherent system accessories

For easy installation fastening straps are available as rolls or in prefabricated lengths as well as tightening tools. Matching construction and suspension profiles complete the system.



Cable ladder, light-duty SL 42...

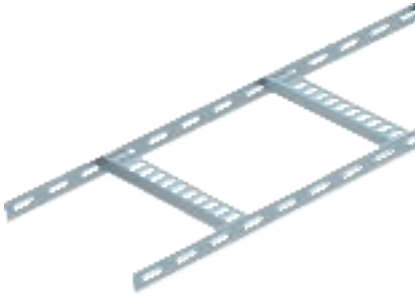

| Width in mm | SG welding primed | FT Hot-dip galvanised | A2 Stainless steel | A4 Stainless steel | Alu |
|-------------|-------------------|-----------------------|--------------------|--------------------|-----|
| 75 | ✓ | ✓ | ✓ | ✓ | ✓ |
| 100 | ✓ | ✓ | ✓ | ✓ | ✓ |
| 150 | ✓ | ✓ | ✓ | ✓ | ✓ |
| 200 | ✓ | ✓ | ✓ | ✓ | ✓ |
| 250 | ✓ | ✓ | ✓ | ✓ | ✓ |
| 300 | ✓ | ✓ | ✓ | ✓ | ✓ |

Cable ladder, standard SL 62...

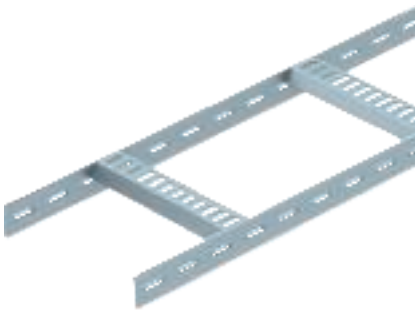

| Width in mm | SG welding primed | FT Hot-dip galvanised | A2 Stainless steel | A4 Stainless steel | Alu |
|-------------|-------------------|-----------------------|--------------------|--------------------|-----|
| 100 | ✓ | ✓ | ✓ | ✓ | ✓ |
| 200 | ✓ | ✓ | ✓ | ✓ | ✓ |
| 300 | ✓ | ✓ | ✓ | ✓ | ✓ |
| 400 | ✓ | ✓ | ✓ | ✓ | ✓ |
| 500 | ✓ | ✓ | ✓ | ✓ | ✓ |
| 600 | ✓ | ✓ | ✓ | ✓ | ✓ |

Cable ladder with Z-rung, light-duty SLZ L...



| Width in mm | SG welding primed | FT Hot-dip galvanised | A2 Stainless steel | A4 Stainless steel | Alu |
|-------------|-------------------|-----------------------|--------------------|--------------------|-----|
| 100 | ✓ | ✓ | ✓ | ✓ | ● |
| 150 | ✓ | ✓ | ✓ | ✓ | ● |
| 200 | ✓ | ✓ | ✓ | ✓ | ● |
| 300 | ✓ | ✓ | ✓ | ✓ | ● |
| 400 | ✓ | ✓ | ✓ | ✓ | ● |
| 500 | ✓ | ✓ | ✓ | ✓ | ● |
| 600 | ✓ | ✓ | ✓ | ✓ | ● |

● on request

Cable ladder with Z-rung, standard SLZ...



| Width in mm | SG welding primed | FT Hot-dip galvanised | A2 Stainless steel | A4 Stainless steel | Alu |
|-------------|-------------------|-----------------------|--------------------|--------------------|-----|
| 100 | ✓ | ✓ | ✓ | ✓ | ✓ |
| 200 | ✓ | ✓ | ✓ | ✓ | ✓ |
| 300 | ✓ | ✓ | ✓ | ✓ | ✓ |
| 400 | ✓ | ✓ | ✓ | ✓ | ✓ |
| 500 | ✓ | ✓ | ✓ | ✓ | ✓ |
| 600 | ✓ | ✓ | ✓ | ✓ | ✓ |
| 700 | ✓ | ✓ | ✓ | ✓ | ✓ |
| 800 | ✓ | ✓ | ✓ | ✓ | ✓ |
| 900 | ✓ | ✓ | ✓ | ✓ | ✓ |
| 1000 | ✓ | ✓ | ✓ | ✓ | ✓ |
| 1200 | ✓ | ✓ | ✓ | ✓ | ✓ |

Cable ladder, light-duty

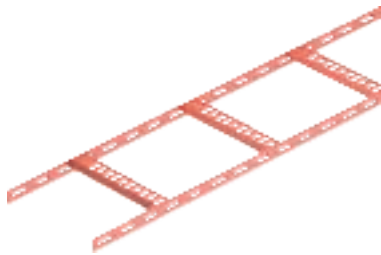

| Type | Width mm | Rail thickness mm | Pack. m | Weight kg/100 m | Item No. |
|--------------|-------------|-------------------------|------------|--------------------|-----------|
| SL 42 075 SG | 75 | 3 | 2 | 109,000 | 7097 02 6 |
| SL 42 100 SG | 100 | 3 | 2 | 112,500 | 7097 03 4 |
| SL 42 150 SG | 150 | 3 | 2 | 119,000 | 7097 04 2 |
| SL 42 200 SG | 200 | 3 | 2 | 125,500 | 7097 05 0 |
| SL 42 250 SG | 250 | 3 | 2 | 132,000 | 7097 06 9 |
| SL 42 300 SG | 300 | 3 | 2 | 139,000 | 7097 07 7 |

Sl Steel

/m

SG welding primed

Marine cable ladder with perforated side rail of side height 25 mm with welded, perforated trapezoidal rungs which open in a downwards direction. Load tested according to IEC in conjunction with connector, type SLV. Welding primer type SIGMA-WELD 199, also available in white.

Dimensions

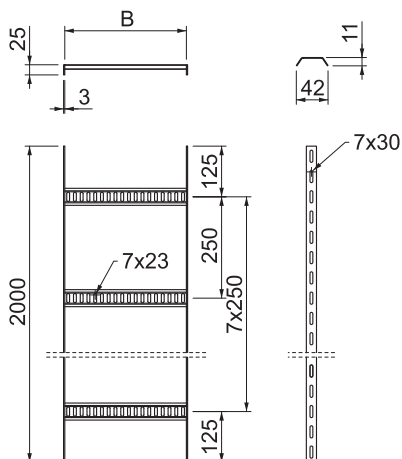

| Type | Length mm | Dimen- sion B mm | Side height mm | Rail thickness mm |
|--------------|--------------|------------------------|----------------------|-------------------------|
| SL 42 075 SG | 2000 | 81 | 25 | 3 |
| SL 42 100 SG | 2000 | 106 | 25 | 3 |
| SL 42 150 SG | 2000 | 156 | 25 | 3 |
| SL 42 200 SG | 2000 | 206 | 25 | 3 |
| SL 42 250 SG | 2000 | 256 | 25 | 3 |
| SL 42 300 SG | 2000 | 306 | 25 | 3 |

Load

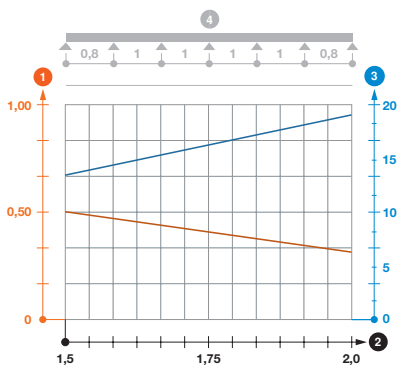

| Type | 1.5 m kN/m | 2.0 m kN/m |
|--------------|---------------|---------------|
| SL 42 075 SG | 0.5 | 0.36 |
| SL 42 100 SG | 0.5 | 0.36 |
| SL 42 150 SG | 0.5 | 0.36 |
| SL 42 200 SG | 0.5 | 0.36 |
| SL 42 250 SG | 0.5 | 0.36 |
| SL 42 300 SG | 0.5 | 0.36 |

1 Permitted cable tray/ladder load in kN/m without man load

2 Support width in m

3 Rail bend in mm at permitted kN/m

— Load curve with cable tray/ladder width in mm

— Strut bend curve according to support width

4 Load scheme during testing

90° bend

| Type | Width mm | Material rail thickness mm | Pack. pcs | Weight kg/100 pcs. | Item No. |
|-------------------------|-------------|-------------------------------------|--------------|-----------------------|------------------|
| SLB 90 42 075 SG | 75 | 3 | 1 | 70,600 | 7098 50 0 |
| SLB 90 42 100 SG | 100 | 3 | 1 | 77,000 | 7098 50 2 |
| SLB 90 42 150 SG | 150 | 3 | 1 | 88,000 | 7098 51 0 |
| SLB 90 42 200 SG | 200 | 3 | 1 | 96,000 | 7098 52 9 |
| SLB 90 42 250 SG | 250 | 3 | 1 | 106,000 | 7098 53 7 |
| SLB 90 42 300 SG | 300 | 3 | 1 | 117,000 | 7098 54 5 |

Sl Steel

SG welding primed

/pc.

Connectors should be ordered separately and in the appropriate quantity.

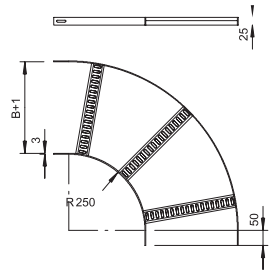

Cable ladder, light-duty

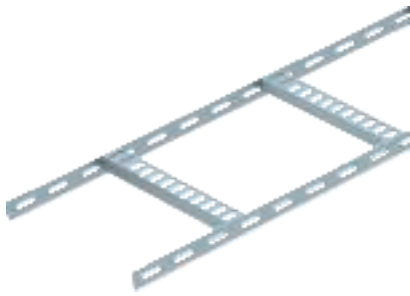

| Type | Width mm | Rail thickness mm | Pack. m | Weight kg/100 m | Item No. |
|--------------|-------------|-------------------------|------------|--------------------|-----------|
| SL 42 075 FT | 75 | 3 | 2 | 114,000 | 7097 11 5 |
| SL 42 100 FT | 100 | 3 | 2 | 118,000 | 7097 12 3 |
| SL 42 150 FT | 150 | 3 | 2 | 125,000 | 7097 13 1 |
| SL 42 200 FT | 200 | 3 | 2 | 132,500 | 7097 15 8 |
| SL 42 250 FT | 250 | 3 | 2 | 140,000 | 7097 16 6 |
| SL 42 300 FT | 300 | 3 | 2 | 147,500 | 7097 17 4 |

Sl Steel

FT Hot-dip galvanised

/m

Marine cable ladder with perforated side rail of side height 25 mm with welded, perforated trapezoidal rungs which open in a downwards direction. Load tested according to IEC in conjunction with connector, type SLV.

Dimensions

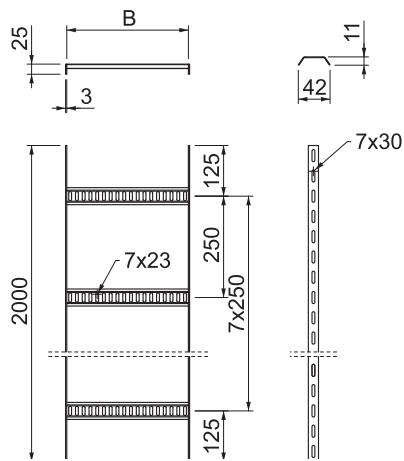

| Type | Length mm | Dimen- sion B mm | Side height mm | Rail thickness mm |
|--------------|--------------|------------------------|----------------------|-------------------------|
| SL 42 075 FT | 2000 | 81 | 25 | 3 |
| SL 42 100 FT | 2000 | 106 | 25 | 3 |
| SL 42 150 FT | 2000 | 156 | 25 | 3 |
| SL 42 200 FT | 2000 | 206 | 25 | 3 |
| SL 42 250 FT | 2000 | 256 | 25 | 3 |
| SL 42 300 FT | 2000 | 306 | 25 | 3 |

Load

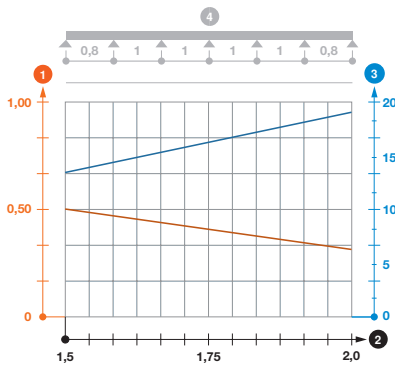

| Type | 1.5 m kN/m | 2.0 m kN/m |
|--------------|---------------|---------------|
| SL 42 075 FT | 0.5 | 0.36 |
| SL 42 100 FT | 0.5 | 0.36 |
| SL 42 150 FT | 0.5 | 0.36 |
| SL 42 200 FT | 0.5 | 0.36 |
| SL 42 250 FT | 0.5 | 0.36 |
| SL 42 300 FT | 0.5 | 0.36 |

Load diagram, cable ladder, light-duty SL42

- 1 Permitted cable tray/ladder load in kN/m without man load
- 2 Support width in m
- 3 Rail bend in mm at permitted kN/m
- Load curve with cable tray/ladder width in mm
- Strut bend curve according to support width
- 4 Load scheme during testing

Straight connector



Type

| Type | Pack. pcs | Weight kg/100 pcs. | Item No. |
|------------------|-----------|--------------------|------------------|
| SLV 42 FT | 20 | 11,900 | 7103 54 0 |

Sl Steel

/pc.

FT Hot-dip galvanised

Straight connector as external connector to connect cable ladders and fittings with a side height of 25 mm.

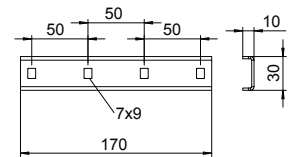
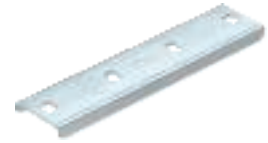

90° bend

| Type | Width rail mm | Material thickness mm | Pack. pcs | Weight kg/100 pcs. | Item No. |
|-------------------------|---------------|-----------------------|-----------|--------------------|------------------|
| SLB 90 42 075 FT | 75 | 3 | 1 | 73,800 | 7098 61 4 |
| SLB 90 42 100 FT | 100 | 3 | 1 | 80,000 | 7098 61 8 |
| SLB 90 42 150 FT | 150 | 3 | 1 | 90,000 | 7098 62 6 |
| SLB 90 42 200 FT | 200 | 3 | 1 | 101,000 | 7098 63 4 |
| SLB 90 42 250 FT | 250 | 3 | 1 | 111,000 | 7098 64 2 |
| SLB 90 42 300 FT | 300 | 3 | 1 | 121,000 | 7098 65 0 |

Sl Steel

/pc.

FT Hot-dip galvanised

Connectors should be ordered separately and in the appropriate quantity.

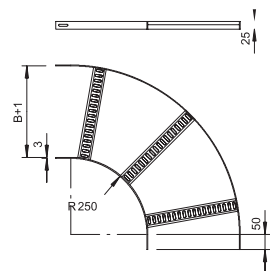

Cable ladder, light-duty

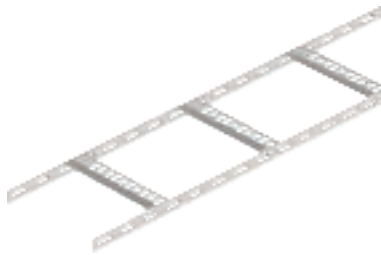

| Type | Rail | | Pack. m | Weight kg/100 m | Item No. |
|--------------|----------|--------------|---------|-----------------|-----------|
| | Width mm | thickness mm | | | |
| SL 42 075 A2 | 75 | 3 | 2 | 109,000 | 7097 08 0 |
| SL 42 100 A2 | 100 | 3 | 2 | 112,500 | 7097 08 2 |
| SL 42 150 A2 | 150 | 3 | 2 | 119,000 | 7097 08 4 |
| SL 42 200 A2 | 200 | 3 | 2 | 125,500 | 7097 08 6 |
| SL 42 250 A2 | 250 | 3 | 2 | 132,000 | 7097 08 8 |
| SL 42 300 A2 | 300 | 3 | 2 | 139,000 | 7097 09 0 |

V2A Stainless steel, A2

/m

GB Pickled

Marine cable ladder with perforated side rail of side height 25 mm with welded, perforated trapezoidal rungs which open in a downwards direction. Load tested according to IEC in conjunction with connector, type SLV.

Dimensions

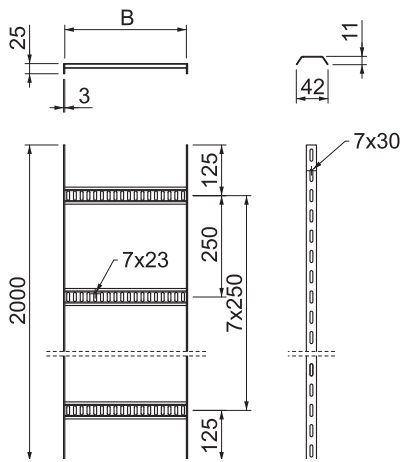

| Type | Length mm | Dimension B mm | Side height mm | Rail | |
|--------------|-----------|----------------|----------------|-----------|--------------|
| | | | | height mm | thickness mm |
| SL 42 075 A2 | 2000 | 81 | 25 | 3 | |
| SL 42 100 A2 | 2000 | 106 | 25 | 3 | |
| SL 42 150 A2 | 2000 | 156 | 25 | 3 | |
| SL 42 200 A2 | 2000 | 206 | 25 | 3 | |
| SL 42 250 A2 | 2000 | 256 | 25 | 3 | |
| SL 42 300 A2 | 2000 | 306 | 25 | 3 | |

Load

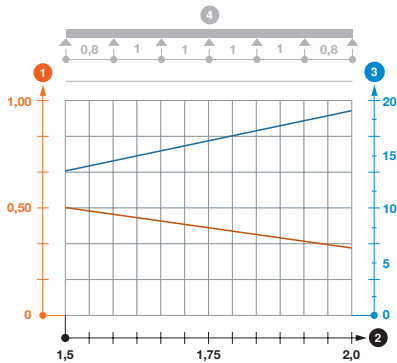

| Type | 1.5 m | 2.0 m |
|--------------|-------|-------|
| | kN/m | kN/m |
| SL 42 075 A2 | 0.5 | 0.36 |
| SL 42 100 A2 | 0.5 | 0.36 |
| SL 42 150 A2 | 0.5 | 0.36 |
| SL 42 200 A2 | 0.5 | 0.36 |
| SL 42 250 A2 | 0.5 | 0.36 |
| SL 42 300 A2 | 0.5 | 0.36 |

- 1 Permitted cable tray/ladder load in kN/m without man load
- 2 Support width in m
- 3 Rail bend in mm at permitted kN/m
- Load curve with cable tray/ladder width in mm
- Strut bend curve according to support width
- 4 Load scheme during testing

Straight connector

| Type | Pack. pcs | Weight kg/100 pcs. | Item No. |
|------------------|-----------|--------------------|------------------|
| SLV 42 A4 | 20 | 11,300 | 7103 56 0 |

V4A Stainless steel, A4 /pc.

Straight connector as external connector to connect cable ladders and fittings with a side height of 25 mm.

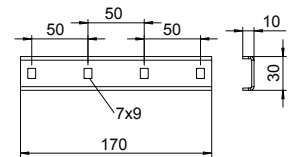

90° bend

| Type | Width rail mm | Material thickness mm | Pack. pcs | Weight kg/100 pcs. | Item No. |
|-------------------------|---------------|-----------------------|-----------|--------------------|------------------|
| SLB 90 42 075 A2 | 75 | 3 | 1 | 71,600 | 7098 65 4 |
| SLB 90 42 100 A2 | 100 | 3 | 1 | 76,400 | 7098 65 6 |
| SLB 90 42 150 A2 | 150 | 3 | 1 | 85,800 | 7098 65 8 |
| SLB 90 42 200 A2 | 200 | 3 | 1 | 95,400 | 7098 66 0 |
| SLB 90 42 250 A2 | 250 | 3 | 1 | 105,000 | 7098 66 2 |
| SLB 90 42 300 A2 | 300 | 3 | 1 | 114,300 | 7098 66 4 |

V2A Stainless steel, A2 /pc.

Connectors should be ordered separately and in the appropriate quantity.

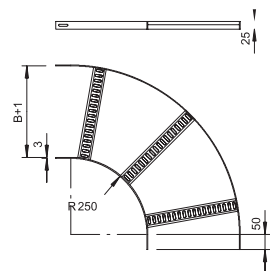

Cable ladder, light-duty

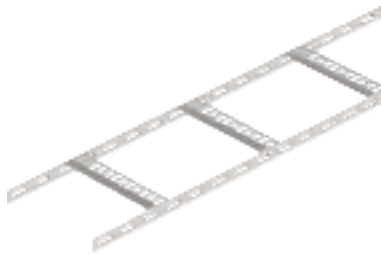

| Type | Rail | | Pack. m | Weight kg/100 m | Item No. |
|--------------|----------|--------------|---------|-----------------|-----------|
| | Width mm | thickness mm | | | |
| SL 42 075 A4 | 75 | 3 | 2 | 110,850 | 7099 70 2 |
| SL 42 100 A4 | 100 | 3 | 2 | 114,500 | 7099 70 4 |
| SL 42 150 A4 | 150 | 3 | 2 | 120,900 | 7099 70 6 |
| SL 42 200 A4 | 200 | 3 | 2 | 127,600 | 7099 70 8 |
| SL 42 250 A4 | 250 | 3 | 2 | 134,300 | 7099 71 0 |
| SL 42 300 A4 | 300 | 3 | 2 | 140,800 | 7099 71 2 |

V4A Stainless steel, A4

/m

GB Pickled

Marine cable ladder with perforated side rail of side height 25 mm with welded, perforated trapezoidal rungs which open in a downwards direction. Load tested according to IEC in conjunction with connector, type SLV.

Dimensions

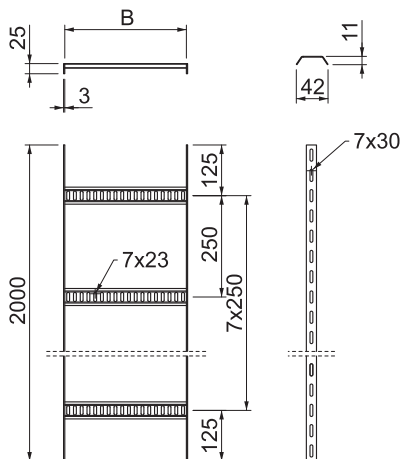

| Type | Length mm | Dimension B mm | Side height mm | Rail | |
|--------------|-----------|----------------|----------------|-----------|--------------|
| | | | | height mm | thickness mm |
| SL 42 075 A4 | 2000 | 81 | 25 | 3 | 3 |
| SL 42 100 A4 | 2000 | 106 | 25 | 3 | 3 |
| SL 42 150 A4 | 2000 | 156 | 25 | 3 | 3 |
| SL 42 200 A4 | 2000 | 206 | 25 | 3 | 3 |
| SL 42 250 A4 | 2000 | 256 | 25 | 3 | 3 |
| SL 42 300 A4 | 2000 | 306 | 25 | 3 | 3 |

Load

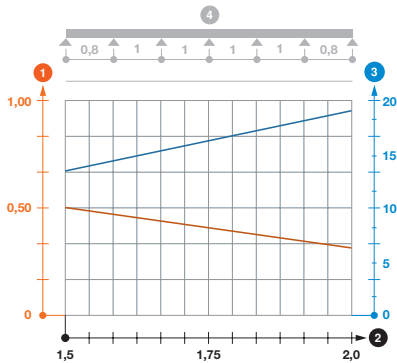

| Type | 1.5 m | 2.0 m |
|--------------|-------|-------|
| | kN/m | kN/m |
| SL 42 075 A4 | 0.5 | 0.36 |
| SL 42 100 A4 | 0.5 | 0.36 |
| SL 42 150 A4 | 0.5 | 0.36 |
| SL 42 200 A4 | 0.5 | 0.36 |
| SL 42 250 A4 | 0.5 | 0.36 |
| SL 42 300 A4 | 0.5 | 0.36 |

- ① Permitted cable tray/ladder load in kN/m without man load
- ② Support width in m
- ③ Rail bend in mm at permitted kN/m
- Load curve with cable tray/ladder width in mm
- Strut bend curve according to support width
- ④ Load scheme during testing

Straight connector

| Type | Pack. pcs | Weight kg/100 pcs. | Item No. |
|------------------|-----------|--------------------|------------------|
| SLV 42 A4 | 20 | 11,300 | 7103 56 0 |

V4A Stainless steel, A4

/pc.

Straight connector as external connector to connect cable ladders and fittings with a side height of 25 mm.

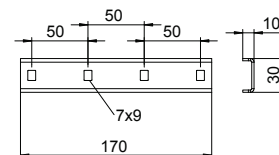

90° bend

| Type | Width rail mm | Material thickness mm | Pack. pcs | Weight kg/100 pcs. | Item No. |
|-------------------------|---------------|-----------------------|-----------|--------------------|------------------|
| SLB 90 42 075 A4 | 75 | 3 | 1 | 71,600 | 7098 67 0 |
| SLB 90 42 100 A4 | 100 | 3 | 1 | 77,000 | 7098 67 2 |
| SLB 90 42 150 A4 | 150 | 3 | 1 | 87,000 | 7098 67 4 |
| SLB 90 42 200 A4 | 200 | 3 | 1 | 97,000 | 7098 67 6 |
| SLB 90 42 250 A4 | 250 | 3 | 1 | 107,000 | 7098 67 8 |
| SLB 90 42 300 A4 | 300 | 3 | 1 | 117,000 | 7098 68 0 |

V4A Stainless steel, A4

/pc.

Connectors should be ordered separately and in the appropriate quantity.

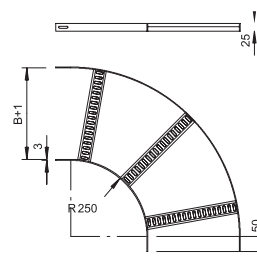

Cable ladder, light-duty



| Type | Width mm | Rail thickness mm | Available from | Pack. m | Weight kg/100 m | Item No. |
|----------------------|-------------|-------------------------|-------------------|------------|--------------------|------------------|
| SL 42 075 ALU | 75 | 3 | 01/2017 | 2 | 13,900 | 7099 72 2 |
| SL 42 100 ALU | 100 | 3 | 01/2017 | 2 | 38,050 | 7099 72 4 |
| SL 42 150 ALU | 150 | 3 | 01/2017 | 2 | 40,350 | 7099 72 6 |
| SL 42 200 ALU | 200 | 3 | 01/2017 | 2 | 42,600 | 7099 72 8 |
| SL 42 250 ALU | 250 | 3 | 01/2017 | 2 | 44,850 | 7099 73 0 |
| SL 42 300 ALU | 300 | 3 | 01/2017 | 2 | 47,100 | 7099 73 2 |

Alu Aluminium

/m

Marine cable ladder with perforated side rail of side height 25 mm with welded, perforated trapezoidal rungs which open in a downwards direction.

Dimensions

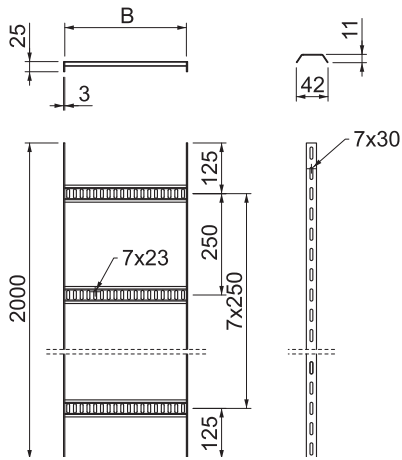

| Type | Length mm | Dimen- sion B mm | Side height mm | Rail thickness mm |
|----------------------|--------------|------------------------|----------------------|-------------------------|
| SL 42 075 ALU | 2000 | 81 | 25 | 3 |
| SL 42 100 ALU | 2000 | 106 | 25 | 3 |
| SL 42 150 ALU | 2000 | 156 | 25 | 3 |
| SL 42 200 ALU | 2000 | 206 | 25 | 3 |
| SL 42 250 ALU | 2000 | 256 | 25 | 3 |
| SL 42 300 ALU | 2000 | 306 | 25 | 3 |

Straight connector



| Type | Available from | Pack. pcs | Weight kg/100 pcs. | Item No. |
|-------------------|-------------------|--------------|-----------------------|------------------|
| SLV 42 ALU | 01/2017 | 1 | 4,900 | 7103 55 2 |

Alu Aluminium

/pc.

Straight connector as external connector to connect cable ladders and fittings with a side height of 25 mm.

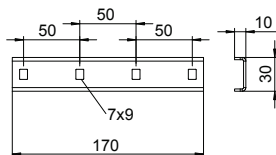

90° bend

| Type | Width mm | rail thickness mm | Available from | Pack. pcs | Weight kg/100 pcs. | Item No. |
|------------------|-------------|-------------------------|-------------------|--------------|-----------------------|-----------|
| SLB 90 42 075ALU | 75 | 3 | 01/2017 | 1 | 24,100 | 7098 68 4 |
| SLB 90 42 100ALU | 100 | 3 | 01/2017 | 1 | 25,700 | 7098 68 6 |
| SLB 90 42 150ALU | 150 | 3 | 01/2017 | 1 | 29,000 | 7098 68 8 |
| SLB 90 42 200ALU | 200 | 3 | 01/2017 | 1 | 32,300 | 7098 69 0 |
| SLB 90 42 250ALU | 250 | 3 | 01/2017 | 1 | 35,500 | 7098 69 2 |
| SLB 90 42 300ALU | 300 | 3 | 01/2017 | 1 | 38,800 | 7098 69 4 |

Alu Aluminium

Connectors should be ordered separately and in the appropriate quantity.

/pc.

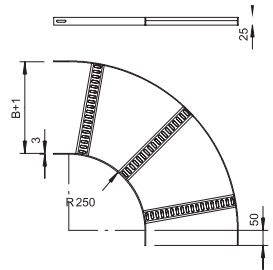

Cable ladder, standard

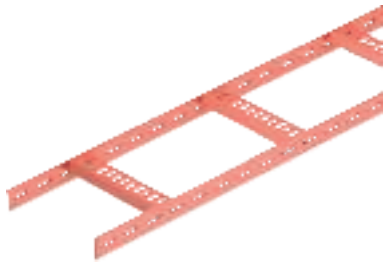

| Type | Width mm | Rail thickness mm | Pack. m | Weight kg/100 m | Item No. |
|--------------|-------------|-------------------------|------------|--------------------|-----------|
| SL 62 100 SG | 100 | 5 | 3 | 299,000 | 7097 21 2 |
| SL 62 150 SG | 150 | 5 | 3 | 315,700 | 7097 22 0 |
| SL 62 200 SG | 200 | 5 | 3 | 332,333 | 7097 23 9 |
| SL 62 300 SG | 300 | 5 | 3 | 365,700 | 7097 24 7 |
| SL 62 400 SG | 400 | 5 | 3 | 398,700 | 7097 25 5 |
| SL 62 500 SG | 500 | 5 | 3 | 432,000 | 7097 26 3 |
| SL 62 600 SG | 600 | 5 | 3 | 465,333 | 7097 27 1 |

Sl Steel

SG welding primed

/m

Marine cable ladder with perforated side rail of side height 40 mm with welded, perforated trapezoidal rungs which open in a downwards direction. Load tested according to IEC in conjunction with connector, type SLV. Welding primer type SIGMA-WELD 199, also available in white.

Dimensions

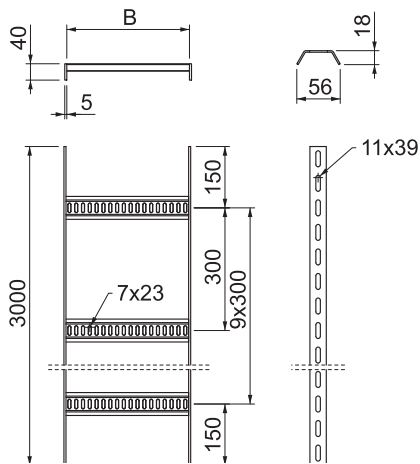

| Type | Length mm | Dimen- sion B mm | Side height mm | Rail thickness mm |
|--------------|--------------|------------------------|----------------------|-------------------------|
| SL 62 100 SG | 3000 | 110 | 40 | 5 |
| SL 62 150 SG | 3000 | 160 | 40 | 5 |
| SL 62 200 SG | 3000 | 210 | 40 | 5 |
| SL 62 300 SG | 3000 | 310 | 40 | 5 |
| SL 62 400 SG | 3000 | 410 | 40 | 5 |
| SL 62 500 SG | 3000 | 510 | 40 | 5 |
| SL 62 600 SG | 3000 | 610 | 40 | 5 |

Load

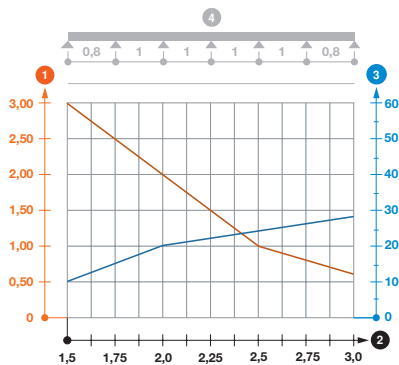

| Type | 1.5 m kN/m | 2.0 m kN/m | 2.5 m kN/m | 3.0 m kN/m |
|--------------|---------------|---------------|---------------|---------------|
| SL 62 100 SG | 3 | 2 | 1 | 0.6 |
| SL 62 150 SG | 3 | 2 | 1 | 0.6 |
| SL 62 200 SG | 3 | 2 | 1 | 0.6 |
| SL 62 300 SG | 3 | 2 | 1 | 0.6 |
| SL 62 400 SG | 3 | 2 | 1 | 0.6 |
| SL 62 500 SG | 3 | 2 | 1 | 0.6 |
| SL 62 600 SG | 3 | 2 | 1 | 0.6 |

1 Permitted cable tray/ladder load in kN/m without man load

2 Support width in m

3 Rail bend in mm at permitted kN/m

— Load curve with cable tray/ladder width in mm

— Strut bend curve according to support width

4 Load scheme during testing

90° bend

| Type | Width mm | Material rail thickness mm | Pack. pcs | Weight kg/100 pcs. | Item No. |
|-------------------------|-------------|-------------------------------------|--------------|-----------------------|------------------|
| SLB 90 62 100 SG | 100 | 5 | 1 | 207,000 | 7098 70 7 |
| SLB 90 62 200 SG | 200 | 5 | 1 | 259,000 | 7098 72 3 |
| SLB 90 62 300 SG | 300 | 5 | 1 | 311,000 | 7098 73 1 |
| SLB 90 62 400 SG | 400 | 5 | 1 | 363,000 | 7098 75 8 |
| SLB 90 62 500 SG | 500 | 5 | 1 | 416,000 | 7098 76 6 |
| SLB 90 62 600 SG | 600 | 5 | 1 | 468,000 | 7098 77 4 |

Sl Steel

SG welding primed

/pc.

Connectors should be ordered separately and in the appropriate quantity.

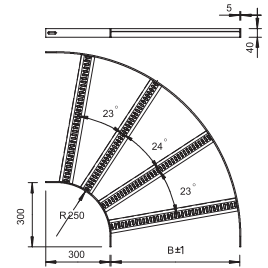

Rung, standard

| Type | Length mm | Pack. m | Weight kg/100 m | Item No. |
|-----------------------|--------------|------------|--------------------|------------------|
| SLSP 62 300 SG | 3000 | 3 | 98,900 | 7102 67 4 |

Sl Steel

SG welding primed

/m

Rung with 7x23 mm perforation. For welding in cable ladders, type SL 62, and for support constructions.

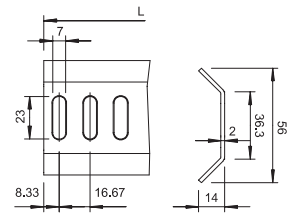

Cable ladder, standard

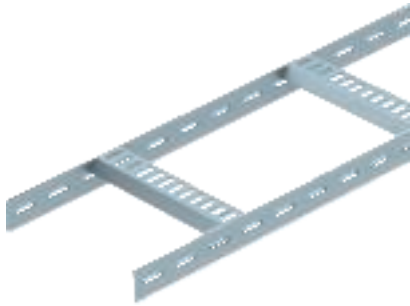

| Type | Width mm | Rail thickness mm | Pack. m | Weight kg/100 m | Item No. |
|--------------|-------------|-------------------------|------------|--------------------|-----------|
| SL 62 100 FT | 100 | 5 | 3 | 307,300 | 7097 40 9 |
| SL 62 150 FT | 150 | 5 | 3 | 325,000 | 7097 41 7 |
| SL 62 200 FT | 200 | 5 | 3 | 342,700 | 7097 42 5 |
| SL 62 300 FT | 300 | 5 | 3 | 378,000 | 7097 43 3 |
| SL 62 400 FT | 400 | 5 | 3 | 413,000 | 7097 44 1 |
| SL 62 500 FT | 500 | 5 | 3 | 448,300 | 7097 46 8 |
| SL 62 600 FT | 600 | 5 | 3 | 483,700 | 7097 47 6 |

Sl Steel

FT Hot-dip galvanised

/m

Marine cable ladder with perforated side rail of side height 40 mm with welded, perforated trapezoidal rungs which open in a downwards direction. Load tested according to IEC in conjunction with connector, type SLV.

Dimensions

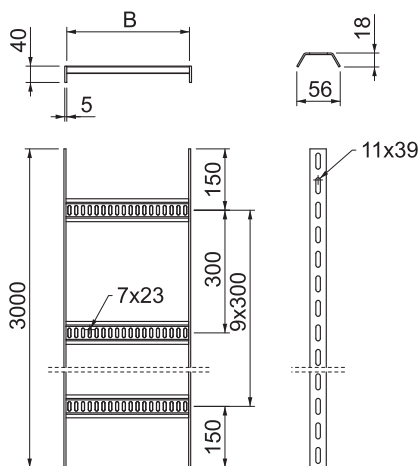

| Type | Length mm | Dimension B mm | Side height mm | Rail thickness mm |
|--------------|--------------|-------------------|----------------------|-------------------------|
| SL 62 100 FT | 3000 | 110 | 40 | 5 |
| SL 62 150 FT | 3000 | 160 | 40 | 5 |
| SL 62 200 FT | 3000 | 210 | 40 | 5 |
| SL 62 300 FT | 3000 | 310 | 40 | 5 |
| SL 62 400 FT | 3000 | 410 | 40 | 5 |
| SL 62 500 FT | 3000 | 510 | 40 | 5 |
| SL 62 600 FT | 3000 | 610 | 40 | 5 |

Load

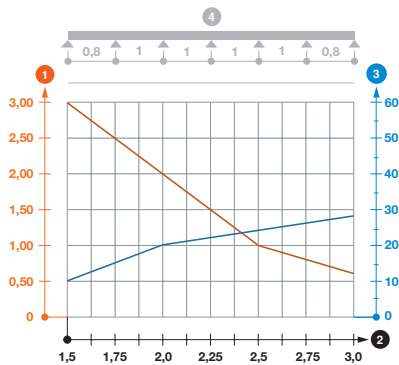

| Type | 1.5 m kN/m | 2.0 m kN/m | 2.5 m kN/m | 3.0 m kN/m |
|--------------|---------------|---------------|---------------|---------------|
| SL 62 100 FT | 3 | 2 | 1 | 0.6 |
| SL 62 150 FT | 3 | 2 | 1 | 0.6 |
| SL 62 200 FT | 3 | 2 | 1 | 0.6 |
| SL 62 300 FT | 3 | 2 | 1 | 0.6 |
| SL 62 400 FT | 3 | 2 | 1 | 0.6 |
| SL 62 500 FT | 3 | 2 | 1 | 0.6 |
| SL 62 600 FT | 3 | 2 | 1 | 0.6 |

Load diagram, cable ladder SL62

- 1 Permitted cable tray/ladder load in kN/m without man load
- 2 Support width in m
- 3 Rail bend in mm at permitted kN/m
- Load curve with cable tray/ladder width in mm
- Strut bend curve according to support width
- 4 Load scheme during testing

Straight connector



| Type | Pack. pcs | Weight kg/100 pcs | Item No. |
|------------------|-----------|-------------------|------------------|
| SLV 62 FT | 10 | 20,900 | 7103 54 8 |

St Steel /pc.
FT Hot-dip galvanised



Straight connector as external connector to connect cable ladders and fittings with a side height of 40 mm.

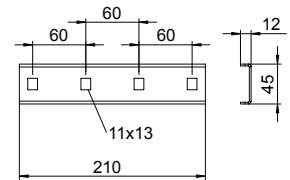

90° bend

| Type | Width rail mm | Material thickness mm | Pack. pcs | Weight kg/100 pcs | Item No. |
|-------------------------|---------------|-----------------------|-----------|-------------------|------------------|
| SLB 90 62 100 FT | 100 | 5 | 1 | 210,000 | 7098 85 5 |
| SLB 90 62 200 FT | 200 | 5 | 1 | 264,000 | 7098 87 1 |
| SLB 90 62 300 FT | 300 | 5 | 1 | 318,000 | 7098 89 8 |
| SLB 90 62 400 FT | 400 | 5 | 1 | 372,000 | 7098 90 1 |
| SLB 90 62 500 FT | 500 | 5 | 1 | 426,000 | 7098 92 8 |
| SLB 90 62 600 FT | 600 | 5 | 1 | 480,000 | 7098 93 6 |

St Steel /pc.
FT Hot-dip galvanised

Connectors should be ordered separately and in the appropriate quantity.

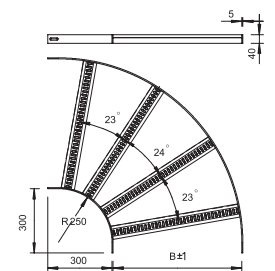

Rung, standard

| Type | Length mm | Pack. m | Weight kg/100 m | Item No. |
|-----------------------|-----------|---------|-----------------|------------------|
| SLSP 62 300 FT | 3000 | 3 | 104,800 | 7102 77 1 |

St Steel /m
FT Hot-dip galvanised

Rung with 7x23 mm perforation. For welding in cable ladders, type SL 62, and for support constructions.

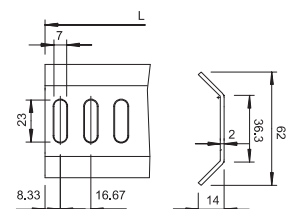
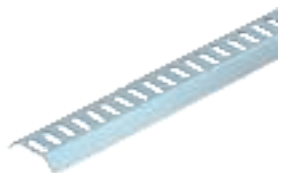

Cable ladder, standard

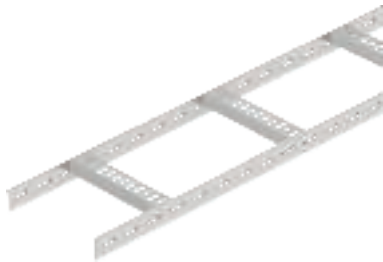

| Type | Width mm | Rail thickness mm | Pack. m | Weight kg/100 m | Item No. |
|--------------|-------------|-------------------------|------------|--------------------|-----------|
| SL 62 100 A2 | 100 | 5 | 3 | 299,000 | 7097 09 4 |
| SL 62 200 A2 | 200 | 5 | 3 | 332,340 | 7097 09 6 |
| SL 62 300 A2 | 300 | 5 | 3 | 365,340 | 7097 09 8 |
| SL 62 400 A2 | 400 | 5 | 3 | 398,670 | 7097 10 0 |
| SL 62 500 A2 | 500 | 5 | 3 | 432,000 | 7097 10 2 |
| SL 62 600 A2 | 600 | 5 | 3 | 465,340 | 7097 10 4 |

V2A Stainless steel, A2

/m

GB Pickled

Marine cable ladder with perforated side rail of side height 40 mm with welded, perforated trapezoidal rungs which open in a downwards direction. Load tested according to IEC in conjunction with connector, type SLV.

Dimensions

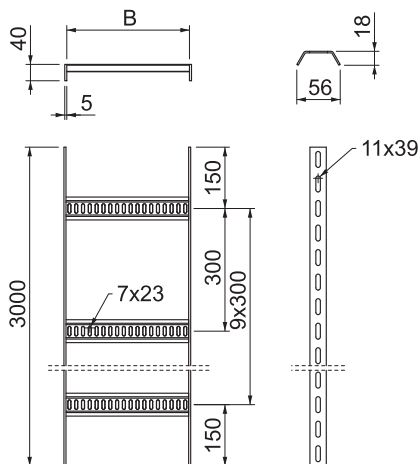

| Type | Length mm | Dimen- sion B mm | Side height mm | Rail thickness mm |
|--------------|--------------|------------------------|----------------------|-------------------------|
| SL 62 100 A2 | 3000 | 110 | 40 | 5 |
| SL 62 200 A2 | 3000 | 210 | 40 | 5 |
| SL 62 300 A2 | 3000 | 310 | 40 | 5 |
| SL 62 400 A2 | 3000 | 410 | 40 | 5 |
| SL 62 500 A2 | 3000 | 510 | 40 | 5 |
| SL 62 600 A2 | 3000 | 610 | 40 | 5 |

Load

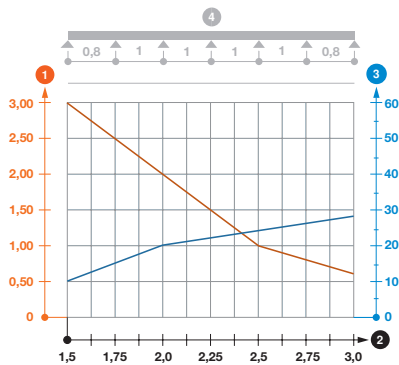

| Type | 1.5 m kN/m | 2.0 m kN/m | 2.5 m kN/m | 3.0 m kN/m |
|--------------|---------------|---------------|---------------|---------------|
| SL 62 100 A2 | 3 | 2 | 1 | 0.6 |
| SL 62 200 A2 | 3 | 2 | 1 | 0.6 |
| SL 62 300 A2 | 3 | 2 | 1 | 0.6 |
| SL 62 400 A2 | 3 | 2 | 1 | 0.6 |
| SL 62 500 A2 | 3 | 2 | 1 | 0.6 |
| SL 62 600 A2 | 3 | 2 | 1 | 0.6 |

- 1 Permitted cable tray/ladder load in kN/m without man load
- 2 Support width in m
- 3 Rail bend in mm at permitted kN/m
- Load curve with cable tray/ladder width in mm
- Strut bend curve according to support width
- 4 Load scheme during testing

Straight connector

| Type | Pack. pcs | Weight kg/100 pcs. | Item No. |
|------------------|-----------|--------------------|------------------|
| SLV 62 A4 | 10 | 14,600 | 7103 56 8 |

V4A Stainless steel, A4

/pc.

Straight connector as external connector to connect cable ladders and fittings with a side height of 40 mm.

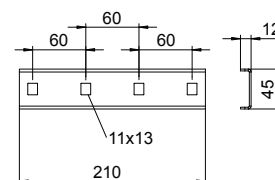

90° bend

| Type | Width rail mm | Material thickness mm | Pack. pcs | Weight kg/100 pcs. | Item No. |
|-------------------------|---------------|-----------------------|-----------|--------------------|------------------|
| SLB 90 62 100 A2 | 100 | 5 | 1 | 206,800 | 7099 15 0 |
| SLB 90 62 200 A2 | 200 | 5 | 1 | 261,700 | 7099 15 2 |
| SLB 90 62 300 A2 | 300 | 5 | 1 | 316,700 | 7099 15 4 |
| SLB 90 62 400 A2 | 400 | 5 | 1 | 371,600 | 7099 15 6 |
| SLB 90 62 500 A2 | 500 | 5 | 1 | 426,500 | 7099 15 8 |
| SLB 90 62 600 A2 | 600 | 5 | 1 | 481,400 | 7099 16 0 |

V2A Stainless steel, A2

/pc.

Connectors should be ordered separately and in the appropriate quantity.

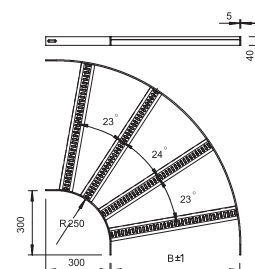

Cable ladder, standard



| Type | Width mm | Rail thickness mm | Pack. m | Weight kg/100 m | Item No. |
|--------------|-------------|-------------------------|------------|--------------------|-----------|
| SL 62 100 A4 | 100 | 5 | 3 | 299,000 | 7097 35 8 |
| SL 62 200 A4 | 200 | 5 | 3 | 332,340 | 7097 36 0 |
| SL 62 300 A4 | 300 | 5 | 3 | 365,340 | 7097 36 2 |
| SL 62 400 A4 | 400 | 5 | 3 | 398,670 | 7097 36 4 |
| SL 62 500 A4 | 500 | 5 | 3 | 432,000 | 7097 36 6 |
| SL 62 600 A4 | 600 | 5 | 3 | 465,340 | 7097 36 8 |

V4A Stainless steel, A4

/m

GB Pickled

Marine cable ladder with perforated side rail of side height 40 mm with welded, perforated trapezoidal rungs which open in a downwards direction. Load tested according to IEC in conjunction with connector, type SLV.

Dimensions

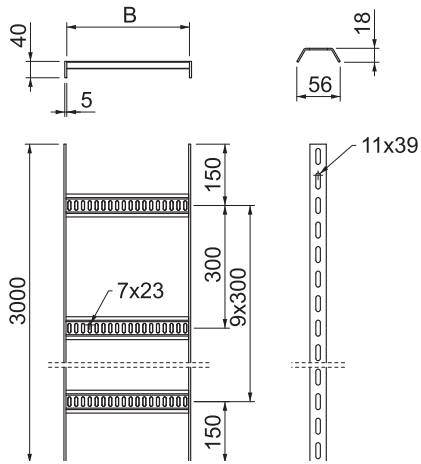

| Type | Length mm | Dimen- sion B mm | Side height mm | Rail thickness mm |
|--------------|--------------|------------------------|----------------------|-------------------------|
| SL 62 100 A4 | 3000 | 110 | 40 | 5 |
| SL 62 200 A4 | 3000 | 210 | 40 | 5 |
| SL 62 300 A4 | 3000 | 310 | 40 | 5 |
| SL 62 400 A4 | 3000 | 410 | 40 | 5 |
| SL 62 500 A4 | 3000 | 510 | 40 | 5 |
| SL 62 600 A4 | 3000 | 610 | 40 | 5 |

Load

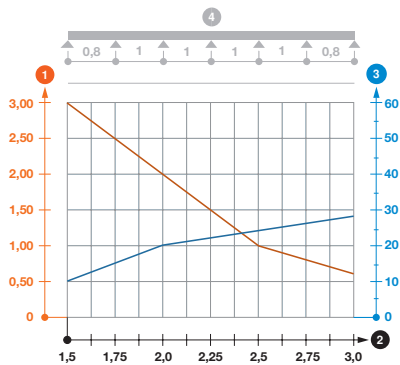

| Type | 1.5 m kN/m | 2.0 m kN/m | 2.5 m kN/m | 3.0 m kN/m |
|--------------|---------------|---------------|---------------|---------------|
| SL 62 100 A4 | 3 | 2 | 1 | 0.6 |
| SL 62 200 A4 | 3 | 2 | 1 | 0.6 |
| SL 62 300 A4 | 3 | 2 | 1 | 0.6 |
| SL 62 400 A4 | 3 | 2 | 1 | 0.6 |
| SL 62 500 A4 | 3 | 2 | 1 | 0.6 |
| SL 62 600 A4 | 3 | 2 | 1 | 0.6 |

- ① Permitted cable tray/ladder load in kN/m without man load
- ② Support width in m
- ③ Rail bend in mm at permitted kN/m
- Load curve with cable tray/ladder width in mm
- Strut bend curve according to support width
- ④ Load scheme during testing

Straight connector

| Type | Pack. pcs | Weight kg/100 pcs. | Item No. |
|------------------|-----------|--------------------|------------------|
| SLV 62 A4 | 10 | 14,600 | 7103 56 8 |

V4A Stainless steel, A4

/pc.

Straight connector as external connector to connect cable ladders and fittings with a side height of 40 mm.

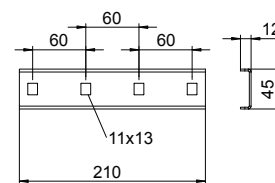

90° bend

| Type | Width rail mm | Material thickness mm | Pack. pcs | Weight kg/100 pcs. | Item No. |
|-------------------------|---------------|-----------------------|-----------|--------------------|------------------|
| SLB 90 62 100 A4 | 100 | 5 | 1 | 209,000 | 7099 16 8 |
| SLB 90 62 200 A4 | 200 | 5 | 1 | 265,000 | 7099 17 0 |
| SLB 90 62 300 A4 | 300 | 5 | 1 | 321,000 | 7099 17 2 |
| SLB 90 62 400 A4 | 400 | 5 | 1 | 376,000 | 7099 17 4 |
| SLB 90 62 500 A4 | 500 | 5 | 1 | 432,000 | 7099 17 6 |
| SLB 90 62 600 A4 | 600 | 5 | 1 | 488,000 | 7099 17 8 |

V4A Stainless steel, A4

/pc.

Connectors should be ordered separately and in the appropriate quantity.

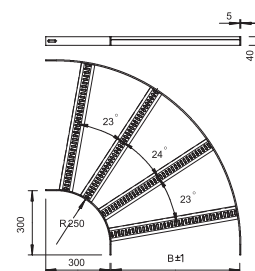

Cable ladder, standard



| Type | Width mm | Rail thickness mm | Available from | Pack. m | Weight kg/100 m | Item No. |
|----------------------|-------------|-------------------------|-------------------|------------|--------------------|------------------|
| SL 62 100 ALU | 100 | 5 | 01/2017 | 3 | 99,800 | 7099 75 2 |
| SL 62 200 ALU | 200 | 5 | 01/2017 | 3 | 111,070 | 7099 75 4 |
| SL 62 300 ALU | 300 | 5 | 01/2017 | 3 | 122,300 | 7099 75 6 |
| SL 62 400 ALU | 400 | 5 | 01/2017 | 3 | 133,570 | 7099 75 8 |
| SL 62 500 ALU | 500 | 5 | 01/2017 | 3 | 144,840 | 7099 76 0 |
| SL 62 600 ALU | 600 | 5 | 01/2017 | 3 | 156,100 | 7099 76 2 |

Alu Aluminium

/m

Marine cable ladder with perforated side rail of side height 40 mm with welded, perforated trapezoidal rungs which open in a downwards direction.

Dimensions

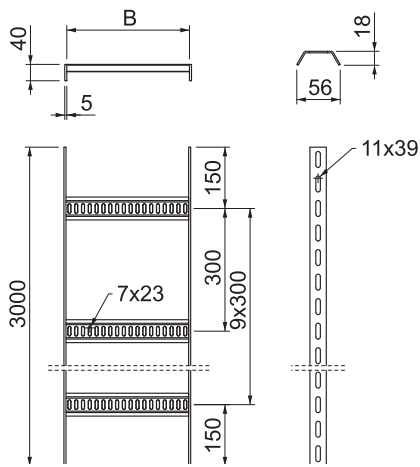

| Type | Length mm | Dimen- sion B mm | Side height mm | Rail thickness mm |
|----------------------|--------------|------------------------|----------------------|-------------------------|
| SL 62 100 ALU | 3000 | 110 | 40 | 5 |
| SL 62 200 ALU | 3000 | 210 | 40 | 5 |
| SL 62 300 ALU | 3000 | 310 | 40 | 5 |
| SL 62 400 ALU | 3000 | 410 | 40 | 5 |
| SL 62 500 ALU | 3000 | 510 | 40 | 5 |
| SL 62 600 ALU | 3000 | 610 | 40 | 5 |

Straight connector

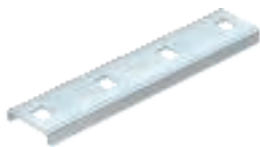

| Type | Available from | Available from | Pack. pcs | Weight kg/100 pcs. | Item No. |
|-------------------|-------------------|-------------------|--------------|-----------------------|------------------|
| SLV 62 ALU | | 01/2017 | 1 | 12,500 | 7103 55 4 |

Alu Aluminium

/pc.

Straight connector as external connector to connect cable ladders and fittings with a side height of 40 mm.

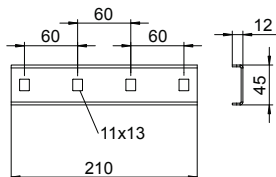

90° bend

| Type | Width mm | rail thickness mm | Available from | Pack. pcs | Weight kg/100 pcs. | Item No. |
|-------------------------|-------------|-------------------------|-------------------|--------------|-----------------------|------------------|
| SLB 90 62 100ALU | 100 | 5 | 01/2017 | 1 | 69,600 | 7099 18 6 |
| SLB 90 62 200ALU | 200 | 5 | 01/2017 | 1 | 88,100 | 7099 18 8 |
| SLB 90 62 300ALU | 300 | 5 | 01/2017 | 1 | 106,600 | 7099 19 0 |
| SLB 90 62 400ALU | 400 | 5 | 01/2017 | 1 | 125,100 | 7099 19 2 |
| SLB 90 62 500ALU | 500 | 5 | 01/2017 | 1 | 143,600 | 7099 19 4 |
| SLB 90 62 600ALU | 600 | 5 | 01/2017 | 1 | 162,100 | 7099 19 6 |

Alu Aluminium

/pc.

Connectors should be ordered separately and in the appropriate quantity.

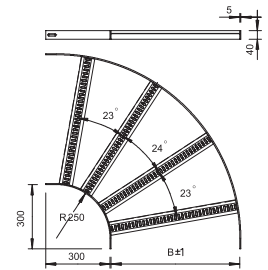

Cable ladder with Z-rung, light-duty

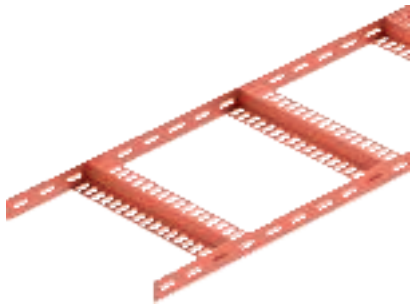

| Type | Width mm | Rail thickness mm | Pack. m | Weight kg/100 m | Item No. |
|--------------|-------------|-------------------------|------------|--------------------|-----------|
| SLZ L 100 SG | 100 | 3 | 3 | 167,000 | 7098 03 2 |
| SLZ L 150 SG | 150 | 3 | 3 | 177,340 | 7098 03 4 |
| SLZ L 200 SG | 200 | 3 | 3 | 187,670 | 7098 03 6 |
| SLZ L 300 SG | 300 | 3 | 3 | 208,670 | 7098 03 8 |
| SLZ L 400 SG | 400 | 3 | 3 | 229,340 | 7098 04 0 |
| SLZ L 500 SG | 500 | 3 | 3 | 250,000 | 7098 04 2 |
| SLZ L 600 SG | 600 | 3 | 3 | 270,670 | 7098 04 4 |

Sl Steel

SG welding primed

/m

Marine cable ladder with perforated side rail of side height 35 mm with welded, perforated Z-rungs. Load tested according to IEC in conjunction with connector, type SLV. Welding primer type SIGMA-WELD 199, also available in white.

Dimensions

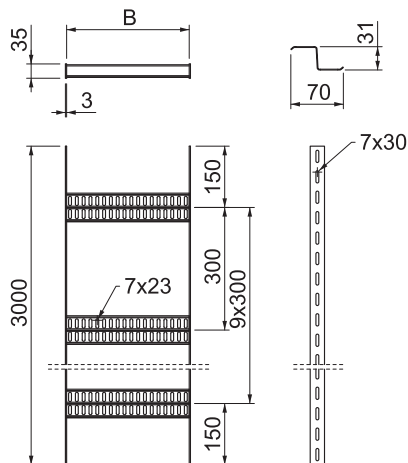

| Type | Length mm | Dimen- sion B mm | Side height mm | Rail thickness mm |
|--------------|--------------|------------------------|----------------------|-------------------------|
| SLZ L 100 SG | 3000 | 106 | 35 | 3 |
| SLZ L 150 SG | 3000 | 156 | 35 | 3 |
| SLZ L 200 SG | 3000 | 206 | 35 | 3 |
| SLZ L 300 SG | 3000 | 306 | 35 | 3 |
| SLZ L 400 SG | 3000 | 406 | 35 | 3 |
| SLZ L 500 SG | 3000 | 506 | 35 | 3 |
| SLZ L 600 SG | 3000 | 606 | 35 | 3 |

Load

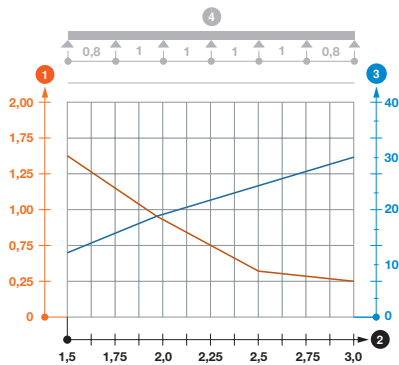

| Type | 1.5 m kN/m | 2.0 m kN/m | 2.5 m kN/m | 3.0 m kN/m |
|--------------|---------------|---------------|---------------|---------------|
| SLZ L 100 SG | 1.5 | 0.85 | 0.35 | 0.25 |
| SLZ L 150 SG | 1.5 | 0.85 | 0.35 | 0.25 |
| SLZ L 200 SG | 1.5 | 0.85 | 0.35 | 0.25 |
| SLZ L 300 SG | 1.5 | 0.85 | 0.35 | 0.25 |
| SLZ L 400 SG | 1.5 | 0.85 | 0.35 | 0.25 |
| SLZ L 500 SG | 1.5 | 0.85 | 0.35 | 0.25 |
| SLZ L 600 SG | 1.5 | 0.85 | 0.35 | 0.25 |

Load diagram, cable ladder SLZ L

- ① Permitted cable tray/ladder load in kN/m without man load
- ② Support width in m
- ③ Rail bend in mm at permitted kN/m
- Load curve with cable tray/ladder width in mm
- Strut bend curve according to support width
- ④ Load scheme during testing

90° bend

| Type | Width rail | | Material thickness mm | Pack. pcs | Weight kg/100 pcs. | Item No. |
|------------------|------------|----|--------------------------|-----------|-----------------------|-----------|
| | mm | mm | | | | |
| SLZB L 90 100 SG | 100 | 3 | | 1 | 111,000 | 7099 20 1 |
| SLZB L 90 150 SG | 150 | 3 | | 1 | 127,000 | 7099 20 2 |
| SLZB L 90 200 SG | 200 | 3 | | 1 | 143,000 | 7099 20 3 |
| SLZB L 90 300 SG | 300 | 3 | | 1 | 174,000 | 7099 20 5 |
| SLZB L 90 400 SG | 400 | 3 | | 1 | 206,000 | 7099 20 8 |
| SLZB L 90 500 SG | 500 | 3 | | 1 | 237,000 | 7099 21 0 |
| SLZB L 90 600 SG | 600 | 3 | | 1 | 269,000 | 7099 21 2 |

Sl Steel

SG welding primed

/pc.

Connectors should be ordered separately and in the appropriate quantity.

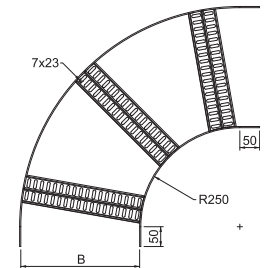

Cable ladder with Z-rung, light-duty

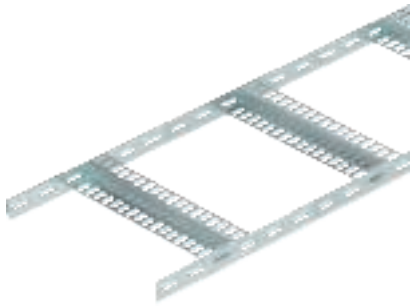

| Type | Width mm | Rail thickness mm | Pack. m | Weight kg/100 m | Item No. |
|--------------|-------------|-------------------------|------------|--------------------|-----------|
| SLZ L 100 FT | 100 | 3 | 3 | 175,340 | 7098 00 2 |
| SLZ L 150 FT | 150 | 3 | 3 | 186,670 | 7098 00 4 |
| SLZ L 200 FT | 200 | 3 | 3 | 198,340 | 7098 00 6 |
| SLZ L 300 FT | 300 | 3 | 3 | 221,670 | 7098 00 8 |
| SLZ L 400 FT | 400 | 3 | 3 | 245,000 | 7098 01 0 |
| SLZ L 500 FT | 500 | 3 | 3 | 268,340 | 7098 01 2 |
| SLZ L 600 FT | 600 | 3 | 3 | 291,670 | 7098 01 4 |

St Steel

/m

FT Hot-dip galvanised

Marine cable ladder with perforated side rail of side height 35 mm with welded, perforated Z-rungs. Load tested according to IEC in conjunction with connector, type SLV.

Dimensions

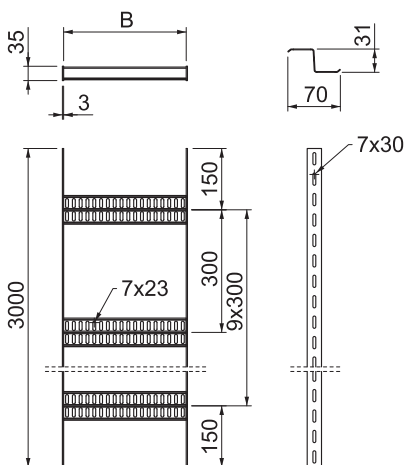

| Type | Length mm | Dimen- sion B mm | Side height mm | Rail thickness mm |
|--------------|--------------|------------------------|----------------------|-------------------------|
| SLZ L 100 FT | 3000 | 106 | 35 | 3 |
| SLZ L 150 FT | 3000 | 156 | 35 | 3 |
| SLZ L 200 FT | 3000 | 206 | 35 | 3 |
| SLZ L 300 FT | 3000 | 306 | 35 | 3 |
| SLZ L 400 FT | 3000 | 406 | 35 | 3 |
| SLZ L 500 FT | 3000 | 506 | 35 | 3 |
| SLZ L 600 FT | 3000 | 606 | 35 | 3 |

Load

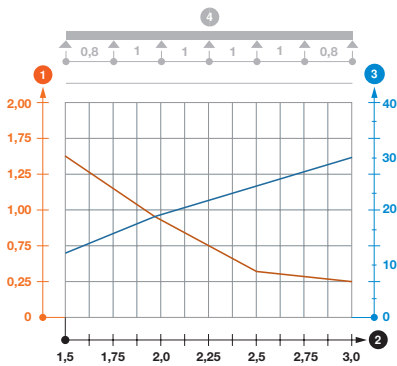

| Type | 1.5 m kN/m | 2.0 m kN/m | 2.5 m kN/m | 3.0 m kN/m |
|--------------|---------------|---------------|---------------|---------------|
| SLZ L 100 FT | 1.5 | 0.85 | 0.35 | 0.25 |
| SLZ L 150 FT | 1.5 | 0.85 | 0.35 | 0.25 |
| SLZ L 200 FT | 1.5 | 0.85 | 0.35 | 0.25 |
| SLZ L 300 FT | 1.5 | 0.85 | 0.35 | 0.25 |
| SLZ L 400 FT | 1.5 | 0.85 | 0.35 | 0.25 |
| SLZ L 500 FT | 1.5 | 0.85 | 0.35 | 0.25 |
| SLZ L 600 FT | 1.5 | 0.85 | 0.35 | 0.25 |

Load diagram, cable ladder SLZ L

- ① Permitted cable tray/ladder load in kN/m without man load
- ② Support width in m
- ③ Rail bend in mm at permitted kN/m
- Load curve with cable tray/ladder width in mm
- Strut bend curve according to support width
- ④ Load scheme during testing

Straight connector



| Type | Pack. pcs | Weight kg/100 pcs. | Item No. |
|------------------|-----------|--------------------|------------------|
| SLV 52 FT | 10 | 14,700 | 7103 54 4 |

St Steel

FT Hot-dip galvanised

/pc.

Straight connector as external connector to connect cable ladders and fittings with a side height of 35 mm.

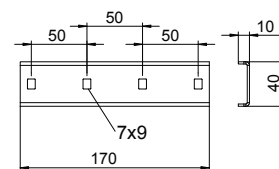

90° bend

| Type | Width rail mm | Material thickness mm | Pack. pcs | Weight kg/100 pcs. | Item No. |
|-------------------------|---------------|-----------------------|-----------|--------------------|------------------|
| SLZB L 90 100 FT | 100 | 3 | 1 | 119,400 | 7099 22 1 |
| SLZB L 90 150 FT | 150 | 3 | 1 | 136,400 | 7099 22 2 |
| SLZB L 90 200 FT | 200 | 3 | 1 | 153,300 | 7099 22 4 |
| SLZB L 90 300 FT | 300 | 3 | 1 | 187,200 | 7099 22 6 |
| SLZB L 90 400 FT | 400 | 3 | 1 | 221,000 | 7099 22 8 |
| SLZB L 90 500 FT | 500 | 3 | 1 | 254,900 | 7099 23 0 |
| SLZB L 90 600 FT | 600 | 3 | 1 | 288,800 | 7099 23 2 |

St Steel

FT Hot-dip galvanised

/pc.

Connectors should be ordered separately and in the appropriate quantity.

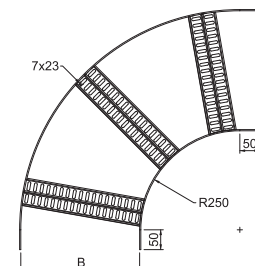

Cable ladder with Z-rung, light-duty

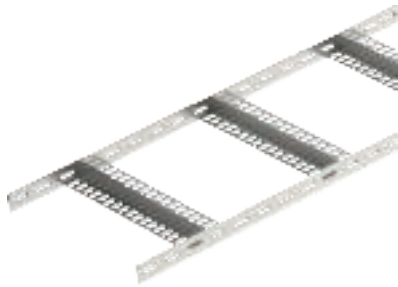

| Type | Rail | | Pack. m | Weight kg/100 m | Item No. |
|--------------|----------|--------------|---------|-----------------|-----------|
| | Width mm | thickness mm | | | |
| SLZ L 100 A2 | 100 | 3 | 3 | 167,000 | 7098 06 2 |
| SLZ L 150 A2 | 150 | 3 | 3 | 177,340 | 7098 06 4 |
| SLZ L 200 A2 | 200 | 3 | 3 | 187,670 | 7098 06 6 |
| SLZ L 300 A2 | 300 | 3 | 3 | 208,670 | 7098 06 8 |
| SLZ L 400 A2 | 400 | 3 | 3 | 229,170 | 7098 07 0 |
| SLZ L 500 A2 | 500 | 3 | 3 | 250,000 | 7098 07 2 |
| SLZ L 600 A2 | 600 | 3 | 3 | 270,670 | 7098 07 4 |

V2A Stainless steel, A2

/m

GB Pickled

Marine cable ladder with perforated side rail of side height 35 mm with welded, perforated Z-rungs. Load tested according to IEC in conjunction with connector, type SLV.

Dimensions

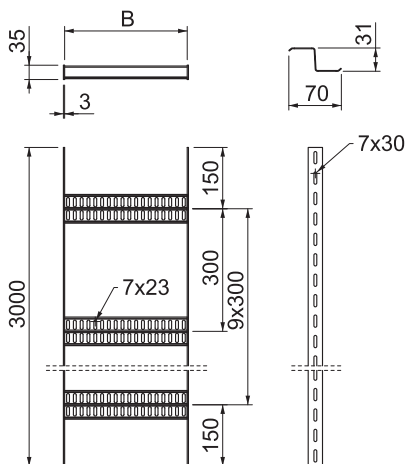

| Type | Length mm | Dimension B mm | Side height mm | Rail thickness mm | |
|--------------|-----------|----------------|----------------|-------------------|----|
| | | | | mm | mm |
| SLZ L 100 A2 | 3000 | 106 | 35 | 3 | 3 |
| SLZ L 150 A2 | 3000 | 156 | 35 | 3 | 3 |
| SLZ L 200 A2 | 3000 | 206 | 35 | 3 | 3 |
| SLZ L 300 A2 | 3000 | 306 | 35 | 3 | 3 |
| SLZ L 400 A2 | 3000 | 406 | 35 | 3 | 3 |
| SLZ L 500 A2 | 3000 | 506 | 35 | 3 | 3 |
| SLZ L 600 A2 | 3000 | 606 | 35 | 3 | 3 |

Load

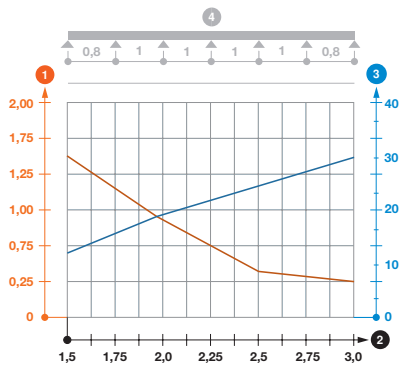

| Type | 1.5 m | 2.0 m | 2.5 m | 3.0 m |
|--------------|-------|-------|-------|-------|
| | kN/m | kN/m | kN/m | kN/m |
| SLZ L 100 A2 | 1.5 | 0.85 | 0.35 | 0.25 |
| SLZ L 150 A2 | 1.5 | 0.85 | 0.35 | 0.25 |
| SLZ L 200 A2 | 1.5 | 0.85 | 0.35 | 0.25 |
| SLZ L 300 A2 | 1.5 | 0.85 | 0.35 | 0.25 |
| SLZ L 400 A2 | 1.5 | 0.85 | 0.35 | 0.25 |
| SLZ L 500 A2 | 1.5 | 0.85 | 0.35 | 0.25 |
| SLZ L 600 A2 | 1.5 | 0.85 | 0.35 | 0.25 |

1 Permitted cable tray/ladder load in kN/m without man load

2 Support width in m

3 Rail bend in mm at permitted kN/m

— Load curve with cable tray/ladder width in mm

— Strut bend curve according to support width

4 Load scheme during testing

Straight connector

| Type | Pack. pcs | Weight kg/100 pcs. | Item No. |
|------------------|-----------|--------------------|------------------|
| SLV 52 A4 | 10 | 14,000 | 7103 56 4 |

V4A Stainless steel, A4

/pc.

Straight connector as external connector to connect cable ladders and fittings with a side height of 35 mm.

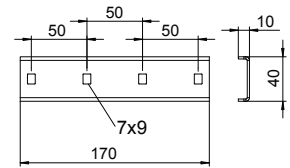

90° bend

| Type | Width mm | Material thickness rail mm | Pack. pcs | Weight kg/100 pcs. | Item No. |
|-------------------------|----------|----------------------------|-----------|--------------------|------------------|
| SLZB L 90 100 A2 | 100 | 3 | 1 | 113,000 | 7099 24 1 |
| SLZB L 90 150 A2 | 150 | 3 | 1 | 129,000 | 7099 24 2 |
| SLZB L 90 200 A2 | 200 | 3 | 1 | 145,000 | 7099 24 3 |
| SLZB L 90 300 A2 | 300 | 3 | 1 | 176,000 | 7099 24 5 |
| SLZB L 90 400 A2 | 400 | 3 | 1 | 208,000 | 7099 24 7 |
| SLZB L 90 500 A2 | 500 | 3 | 1 | 240,000 | 7099 24 9 |
| SLZB L 90 600 A2 | 600 | 3 | 1 | 272,000 | 7099 25 1 |

V2A Stainless steel, A2

/pc.

Connectors should be ordered separately and in the appropriate quantity.

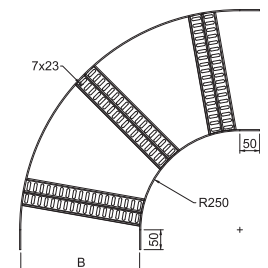

Cable ladder with Z-rung, light-duty

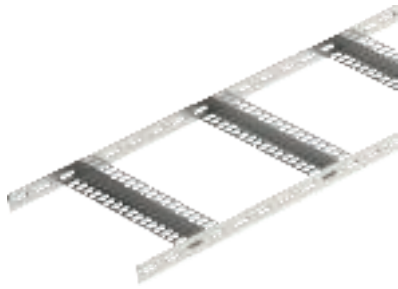

| Type | Rail | | Pack. m | Weight kg/100 m | Item No. |
|--------------|----------|--------------|---------|-----------------|-----------|
| | Width mm | thickness mm | | | |
| SLZ L 100 A4 | 100 | 3 | 3 | 167,000 | 7098 08 2 |
| SLZ L 150 A4 | 150 | 3 | 3 | 177,340 | 7098 08 4 |
| SLZ L 200 A4 | 200 | 3 | 3 | 187,670 | 7098 08 6 |
| SLZ L 300 A4 | 300 | 3 | 3 | 208,670 | 7098 08 8 |
| SLZ L 400 A4 | 400 | 3 | 3 | 229,340 | 7098 09 0 |
| SLZ L 500 A4 | 500 | 3 | 3 | 250,000 | 7098 09 2 |
| SLZ L 600 A4 | 600 | 3 | 3 | 270,670 | 7098 09 4 |

V4A Stainless steel, A4

/m

GB Pickled

Marine cable ladder with perforated side rail of side height 35 mm with welded, perforated Z-rungs. Load tested according to IEC in conjunction with connector, type SLV.

Dimensions

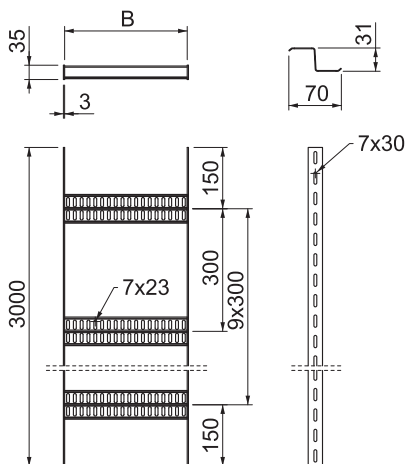

| Type | Length mm | Dimension B mm | Side height mm | Rail thickness mm | |
|--------------|-----------|----------------|----------------|-------------------|--------|
| | | | | width | height |
| SLZ L 100 A4 | 3000 | 106 | 35 | 3 | 3 |
| SLZ L 150 A4 | 3000 | 156 | 35 | 3 | 3 |
| SLZ L 200 A4 | 3000 | 206 | 35 | 3 | 3 |
| SLZ L 300 A4 | 3000 | 306 | 35 | 3 | 3 |
| SLZ L 400 A4 | 3000 | 406 | 35 | 3 | 3 |
| SLZ L 500 A4 | 3000 | 506 | 35 | 3 | 3 |
| SLZ L 600 A4 | 3000 | 606 | 35 | 3 | 3 |

Load

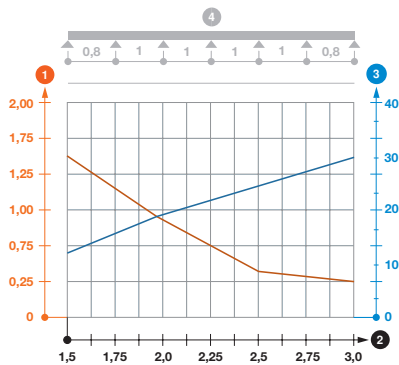

| Type | 1.5 m | 2.0 m | 2.5 m | 3.0 m |
|--------------|-------|-------|-------|-------|
| | kN/m | kN/m | kN/m | kN/m |
| SLZ L 100 A4 | 1.5 | 0.85 | 0.35 | 0.25 |
| SLZ L 150 A4 | 1.5 | 0.85 | 0.35 | 0.25 |
| SLZ L 200 A4 | 1.5 | 0.85 | 0.35 | 0.25 |
| SLZ L 300 A4 | 1.5 | 0.85 | 0.35 | 0.25 |
| SLZ L 400 A4 | 1.5 | 0.85 | 0.35 | 0.25 |
| SLZ L 500 A4 | 1.5 | 0.85 | 0.35 | 0.25 |
| SLZ L 600 A4 | 1.5 | 0.85 | 0.35 | 0.25 |

1 Permitted cable tray/ladder load in kN/m without man load

2 Support width in m

3 Rail bend in mm at permitted kN/m

— Load curve with cable tray/ladder width in mm

— Strut bend curve according to support width

4 Load scheme during testing

Straight connector

| Type | Pack. pcs | Weight kg/100 pcs. | Item No. |
|------------------|-----------|--------------------|------------------|
| SLV 52 A4 | 10 | 14,000 | 7103 56 4 |

V4A Stainless steel, A4

/pc.

Straight connector as external connector to connect cable ladders and fittings with a side height of 35 mm.

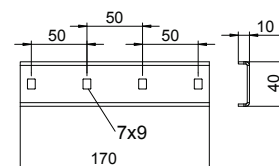

90° bend

| Type | Width rail mm | Material thickness mm | Pack. pcs | Weight kg/100 pcs. | Item No. |
|-------------------------|---------------|-----------------------|-----------|--------------------|------------------|
| SLZB L 90 100 A4 | 100 | 3 | 1 | 114,000 | 7099 26 1 |
| SLZB L 90 150 A4 | 150 | 3 | 1 | 130,200 | 7099 26 2 |
| SLZB L 90 200 A4 | 200 | 3 | 1 | 146,400 | 7099 26 3 |
| SLZB L 90 300 A4 | 300 | 3 | 1 | 178,700 | 7099 26 5 |
| SLZB L 90 400 A4 | 400 | 3 | 1 | 211,000 | 7099 26 8 |
| SLZB L 90 500 A4 | 500 | 3 | 1 | 243,400 | 7099 27 0 |
| SLZB L 90 600 A4 | 600 | 3 | 1 | 275,700 | 7099 27 2 |

V4A Stainless steel, A4

/pc.

Connectors should be ordered separately and in the appropriate quantity.

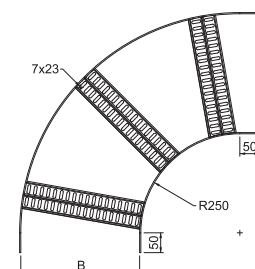

Cable ladder with Z-rung, standard

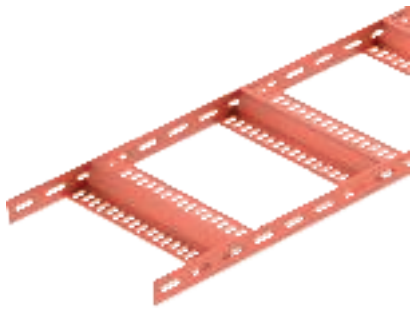

| Type | Width mm | Rail thickness mm | Pack. m | Weight kg/100 m | Item No. |
|-------------|-------------|-------------------------|------------|--------------------|-----------|
| SLZ 100 SG | 100 | 5 | 3 | 319,000 | 7098 16 2 |
| SLZ 200 SG | 200 | 5 | 3 | 372,300 | 7098 16 4 |
| SLZ 300 SG | 300 | 5 | 3 | 425,700 | 7098 16 6 |
| SLZ 400 SG | 400 | 5 | 3 | 479,000 | 7098 16 8 |
| SLZ 500 SG | 500 | 5 | 3 | 532,300 | 7098 17 0 |
| SLZ 600 SG | 600 | 5 | 3 | 585,700 | 7098 17 2 |
| SLZ 700 SG | 700 | 5 | 3 | 639,000 | 7098 17 4 |
| SLZ 800 SG | 800 | 5 | 3 | 692,300 | 7098 17 6 |
| SLZ 900 SG | 900 | 5 | 3 | 745,700 | 7098 17 8 |
| SLZ 1000 SG | 1000 | 5 | 3 | 799,000 | 7098 18 0 |
| SLZ 1200 SG | 1200 | 5 | 3 | 905,300 | 7098 18 2 |

Sl Steel

SG welding primed

/m

Marine cable ladder with perforated side rail of side height 40 mm with welded, perforated Z-rungs. Load tested according to IEC in conjunction with connector, type SLV. Welding primer type SIGMA-WELD 199, also available in white.

Dimensions

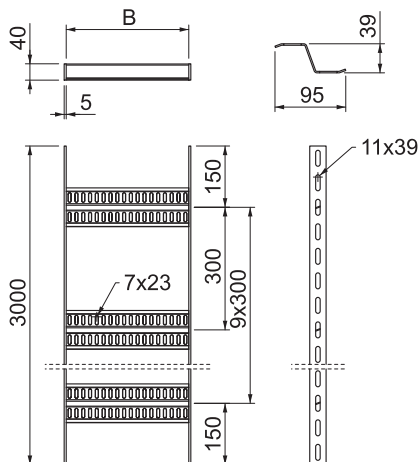

| Type | Length mm | Dimen- sion B mm | Side height mm | Rail thickness mm |
|-------------|--------------|------------------------|----------------------|-------------------------|
| SLZ 100 SG | 3000 | 110 | 40 | 5 |
| SLZ 200 SG | 3000 | 210 | 40 | 5 |
| SLZ 300 SG | 3000 | 310 | 40 | 5 |
| SLZ 400 SG | 3000 | 410 | 40 | 5 |
| SLZ 500 SG | 3000 | 510 | 40 | 5 |
| SLZ 600 SG | 3000 | 610 | 40 | 5 |
| SLZ 700 SG | 3000 | 710 | 40 | 5 |
| SLZ 800 SG | 3000 | 810 | 40 | 5 |
| SLZ 900 SG | 3000 | 910 | 40 | 5 |
| SLZ 1000 SG | 3000 | 1010 | 40 | 5 |
| SLZ 1200 SG | 3000 | 1210 | 40 | 5 |

Load

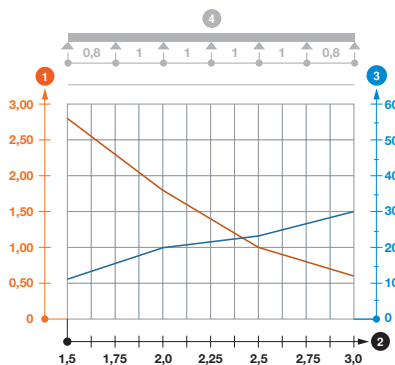

| Type | 1.5 m kN/m | 2.0 m kN/m | 2.5 m kN/m | 3.0 m kN/m |
|-------------|---------------|---------------|---------------|---------------|
| SLZ 100 SG | 2.8 | 1.75 | 1 | 0.6 |
| SLZ 200 SG | 2.8 | 1.75 | 1 | 0.6 |
| SLZ 300 SG | 2.8 | 1.75 | 1 | 0.6 |
| SLZ 400 SG | 2.8 | 1.75 | 1 | 0.6 |
| SLZ 500 SG | 2.8 | 1.75 | 1 | 0.6 |
| SLZ 600 SG | 2.8 | 1.75 | 1 | 0.6 |
| SLZ 700 SG | 2.8 | 1.75 | 1 | 0.6 |
| SLZ 800 SG | 2.8 | 1.75 | 1 | 0.6 |
| SLZ 900 SG | 2.8 | 1.75 | 1 | 0.6 |
| SLZ 1000 SG | 2.8 | 1.75 | 1 | 0.6 |
| SLZ 1200 SG | 2.8 | 1.75 | 1 | 0.6 |

Load diagram, cable ladder SLZ

- 1 Permitted cable tray/ladder load in kN/m without man load
- 2 Support width in m
- 3 Rail bend in mm at permitted kN/m
- Load curve with cable tray/ladder width in mm
- Strut bend curve according to support width
- 4 Load scheme during testing

90° bend

| Type | Width mm | Material thickness rail mm | Pack. pcs | Weight kg/100 pcs. | Item No. |
|-----------------|-------------|-------------------------------------|--------------|-----------------------|-----------|
| SLZB 90 100 SG | 100 | 5 | 1 | 222,200 | 7098 97 6 |
| SLZB 90 200 SG | 200 | 5 | 1 | 295,100 | 7098 97 8 |
| SLZB 90 300 SG | 300 | 5 | 1 | 338,600 | 7098 98 0 |
| SLZB 90 400 SG | 400 | 5 | 1 | 441,300 | 7098 98 2 |
| SLZB 90 500 SG | 500 | 5 | 1 | 514,000 | 7098 98 4 |
| SLZB 90 600 SG | 600 | 5 | 1 | 586,600 | 7098 98 6 |
| SLZB 90 700 SG | 700 | 5 | 1 | 771,400 | 7098 98 8 |
| SLZB 90 800 SG | 800 | 5 | 1 | 860,100 | 7098 99 0 |
| SLZB 90 900 SG | 900 | 5 | 1 | 945,000 | 7098 99 2 |
| SLZB 90 1000 SG | 1000 | 5 | 1 | 1.031,200 | 7098 99 4 |
| SLZB 90 1200 SG | 1200 | 5 | 1 | 1.214,600 | 7098 99 6 |

St Steel

SG welding primed

/pc.

Connectors should be ordered separately and in the appropriate quantity.

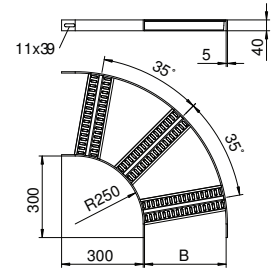

Cable ladder with Z-rung, standard



| Type | Width mm | Rail thickness mm | Pack. m | Weight kg/100 m | Item No. |
|-------------|-------------|-------------------------|------------|--------------------|-----------|
| SLZ 100 FT | 100 | 5 | 3 | 328,700 | 7098 13 2 |
| SLZ 200 FT | 200 | 5 | 3 | 385,300 | 7098 13 4 |
| SLZ 300 FT | 300 | 5 | 3 | 441,700 | 7098 13 6 |
| SLZ 400 FT | 400 | 5 | 3 | 498,300 | 7098 13 8 |
| SLZ 500 FT | 500 | 5 | 3 | 554,700 | 7098 14 0 |
| SLZ 600 FT | 600 | 5 | 3 | 611,300 | 7098 14 2 |
| SLZ 700 FT | 700 | 5 | 3 | 667,700 | 7098 14 4 |
| SLZ 800 FT | 800 | 5 | 3 | 724,300 | 7098 14 6 |
| SLZ 900 FT | 900 | 5 | 3 | 780,700 | 7098 14 8 |
| SLZ 1000 FT | 1000 | 5 | 3 | 837,300 | 7098 15 0 |
| SLZ 1200 FT | 1200 | 5 | 3 | 950,300 | 7098 15 2 |

SI Steel

FT Hot-dip galvanised

/m

Marine cable ladder with perforated side rail of side height 40 mm with welded, perforated Z-rungs. Load tested according to IEC in conjunction with connector, type SLV.

Dimensions

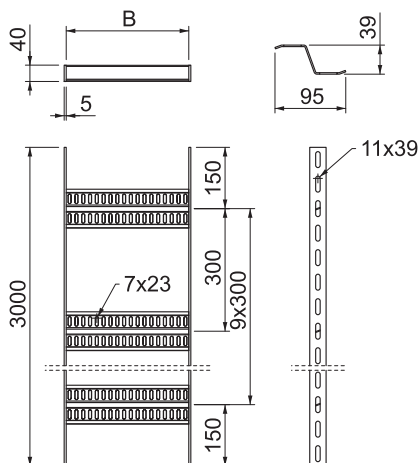

| Type | Length mm | Dimen- sion B mm | Side height mm | Rail thickness mm |
|-------------|--------------|------------------------|----------------------|-------------------------|
| SLZ 100 FT | 3000 | 110 | 40 | 5 |
| SLZ 200 FT | 3000 | 210 | 40 | 5 |
| SLZ 300 FT | 3000 | 310 | 40 | 5 |
| SLZ 400 FT | 3000 | 410 | 40 | 5 |
| SLZ 500 FT | 3000 | 510 | 40 | 5 |
| SLZ 600 FT | 3000 | 610 | 40 | 5 |
| SLZ 700 FT | 3000 | 710 | 40 | 5 |
| SLZ 800 FT | 3000 | 810 | 40 | 5 |
| SLZ 900 FT | 3000 | 910 | 40 | 5 |
| SLZ 1000 FT | 3000 | 1010 | 40 | 5 |
| SLZ 1200 FT | 3000 | 1210 | 40 | 5 |

Load

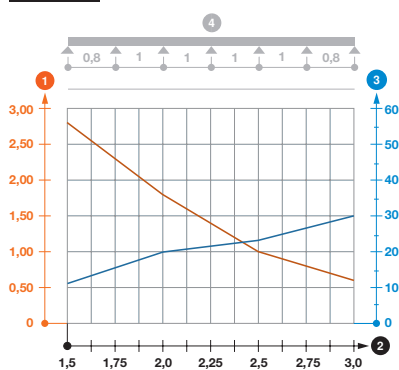

| Type | 1.5 m kN/m | 2.0 m kN/m | 2.5 m kN/m | 3.0 m kN/m |
|-------------|---------------|---------------|---------------|---------------|
| SLZ 100 FT | 2.8 | 1.75 | 1 | 0.6 |
| SLZ 200 FT | 2.8 | 1.75 | 1 | 0.6 |
| SLZ 300 FT | 2.8 | 1.75 | 1 | 0.6 |
| SLZ 400 FT | 2.8 | 1.75 | 1 | 0.6 |
| SLZ 500 FT | 2.8 | 1.75 | 1 | 0.6 |
| SLZ 600 FT | 2.8 | 1.75 | 1 | 0.6 |
| SLZ 700 FT | 2.8 | 1.75 | 1 | 0.6 |
| SLZ 800 FT | 2.8 | 1.75 | 1 | 0.6 |
| SLZ 900 FT | 2.8 | 1.75 | 1 | 0.6 |
| SLZ 1000 FT | 2.8 | 1.75 | 1 | 0.6 |
| SLZ 1200 FT | 2.8 | 1.75 | 1 | 0.6 |

Load diagram, cable ladder SLZ

- 1 Permitted cable tray/ladder load in kN/m without man load
- 2 Support width in m
- 3 Rail bend in mm at permitted kN/m
- Load curve with cable tray/ladder width in mm
- Strut bend curve according to support width
- 4 Load scheme during testing

Straight connector



| Type | Pack. pcs | Weight kg/100 pcs. | Item No. |
|------------------|-----------|--------------------|------------------|
| SLV 62 FT | 10 | 20,900 | 7103 54 8 |

Sl Steel /pc.
FT Hot-dip galvanised



Straight connector as external connector to connect cable ladders and fittings with a side height of 40 mm.

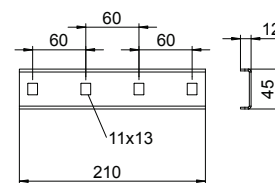

90° bend

| Type | Width rail mm | Material thickness mm | Pack. pcs | Weight kg/100 pcs. | Item No. |
|------------------------|---------------|-----------------------|-----------|--------------------|------------------|
| SLZB 90 100 FT | 100 | 5 | 1 | 231,000 | 7099 00 0 |
| SLZB 90 150 FT | 150 | 5 | 1 | 269,000 | 7099 00 1 |
| SLZB 90 200 FT | 200 | 5 | 1 | 306,500 | 7099 00 2 |
| SLZB 90 300 FT | 300 | 5 | 1 | 382,000 | 7099 00 4 |
| SLZB 90 400 FT | 400 | 5 | 1 | 458,000 | 7099 00 6 |
| SLZB 90 500 FT | 500 | 5 | 1 | 533,000 | 7099 00 8 |
| SLZB 90 600 FT | 600 | 5 | 1 | 609,000 | 7099 01 0 |
| SLZB 90 700 FT | 700 | 5 | 1 | 806,000 | 7099 01 2 |
| SLZB 90 800 FT | 800 | 5 | 1 | 900,000 | 7099 01 4 |
| SLZB 90 900 FT | 900 | 5 | 1 | 994,000 | 7099 01 6 |
| SLZB 90 1000 FT | 1000 | 5 | 1 | 1,088,000 | 7099 01 8 |
| SLZB 90 1200 FT | 1200 | 5 | 1 | 1,276,000 | 7099 02 0 |

Sl Steel /pc.
FT Hot-dip galvanised

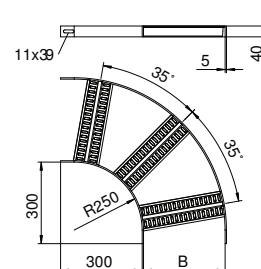

Connectors should be ordered separately and in the appropriate quantity.

Cable ladder with Z-rung, standard

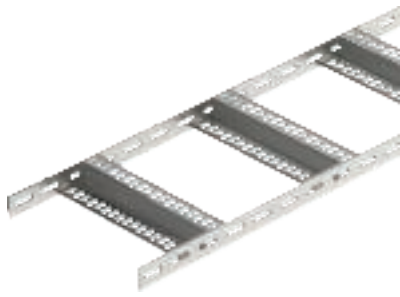

| Type | Width mm | Rail thickness mm | Pack. m | Weight kg/100 m | Item No. |
|-------------|-------------|-------------------------|------------|--------------------|-----------|
| SLZ 100 A2 | 100 | 5 | 3 | 319,000 | 7098 19 2 |
| SLZ 200 A2 | 200 | 5 | 3 | 372,400 | 7098 19 4 |
| SLZ 300 A2 | 300 | 5 | 3 | 425,670 | 7098 19 6 |
| SLZ 400 A2 | 400 | 5 | 3 | 479,000 | 7098 19 8 |
| SLZ 500 A2 | 500 | 5 | 3 | 532,340 | 7098 20 0 |
| SLZ 600 A2 | 600 | 5 | 3 | 585,670 | 7098 20 2 |
| SLZ 700 A2 | 700 | 5 | 3 | 639,000 | 7098 20 4 |
| SLZ 800 A2 | 800 | 5 | 3 | 692,340 | 7098 20 6 |
| SLZ 900 A2 | 900 | 5 | 3 | 745,670 | 7098 20 8 |
| SLZ 1000 A2 | 1000 | 5 | 3 | 799,000 | 7098 21 0 |
| SLZ 1200 A2 | 1200 | 5 | 3 | 905,340 | 7098 21 2 |

V2A Stainless steel, A2

/m

GB Pickled

Marine cable ladder with perforated side rail of side height 40 mm with welded, perforated Z-rungs. Load tested according to IEC in conjunction with connector, type SLV.

Dimensions

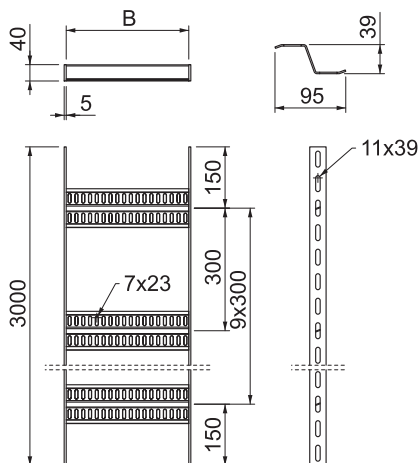

| Type | Length mm | Dimen- sion B mm | Side height mm | Rail thickness mm |
|-------------|--------------|------------------------|----------------------|-------------------------|
| SLZ 100 A2 | 3000 | 110 | 40 | 5 |
| SLZ 200 A2 | 3000 | 210 | 40 | 5 |
| SLZ 300 A2 | 3000 | 310 | 40 | 5 |
| SLZ 400 A2 | 3000 | 410 | 40 | 5 |
| SLZ 500 A2 | 3000 | 510 | 40 | 5 |
| SLZ 600 A2 | 3000 | 610 | 40 | 5 |
| SLZ 700 A2 | 3000 | 710 | 40 | 5 |
| SLZ 800 A2 | 3000 | 810 | 40 | 5 |
| SLZ 900 A2 | 3000 | 910 | 40 | 5 |
| SLZ 1000 A2 | 3000 | 1010 | 40 | 5 |
| SLZ 1200 A2 | 3000 | 1210 | 40 | 5 |

Load

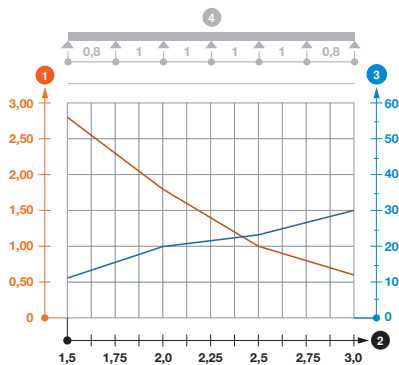

| Type | 1.5 m kN/m | 2.0 m kN/m | 2.5 m kN/m | 3.0 m kN/m |
|-------------|---------------|---------------|---------------|---------------|
| SLZ 100 A2 | 2.8 | 1.75 | 1 | 0.6 |
| SLZ 200 A2 | 2.8 | 1.75 | 1 | 0.6 |
| SLZ 300 A2 | 2.8 | 1.75 | 1 | 0.6 |
| SLZ 400 A2 | 2.8 | 1.75 | 1 | 0.6 |
| SLZ 500 A2 | 2.8 | 1.75 | 1 | 0.6 |
| SLZ 600 A2 | 2.8 | 1.75 | 1 | 0.6 |
| SLZ 700 A2 | 2.8 | 1.75 | 1 | 0.6 |
| SLZ 800 A2 | 2.8 | 1.75 | 1 | 0.6 |
| SLZ 900 A2 | 2.8 | 1.75 | 1 | 0.6 |
| SLZ 1000 A2 | 2.8 | 1.75 | 1 | 0.6 |
| SLZ 1200 A2 | 2.8 | 1.75 | 1 | 0.6 |

1 Permitted cable tray/ladder load in kN/m without man load

2 Support width in m

3 Rail bend in mm at permitted kN/m

— Load curve with cable tray/ladder width in mm

— Strut bend curve according to support width

4 Load scheme during testing

Straight connector

| Type | Pack. pcs | Weight kg/100 pcs. | Item No. |
|------------------|-----------|--------------------|------------------|
| SLV 62 A4 | 10 | 14,600 | 7103 56 8 |

V4A Stainless steel, A4

/pc.

Straight connector as external connector to connect cable ladders and fittings with a side height of 40 mm.

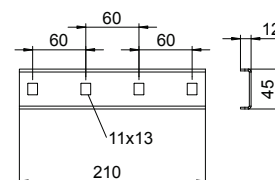

90° bend

| Type | Width rail mm | Material thickness mm | Pack. pcs | Weight kg/100 pcs. | Item No. |
|------------------------|---------------|-----------------------|-----------|--------------------|------------------|
| SLZB 90 100 A2 | 100 | 5 | 1 | 225,100 | 7099 03 0 |
| SLZB 90 200 A2 | 200 | 5 | 1 | 298,300 | 7099 03 2 |
| SLZB 90 300 A2 | 300 | 5 | 1 | 371,500 | 7099 03 4 |
| SLZB 90 400 A2 | 400 | 5 | 1 | 444,600 | 7099 03 6 |
| SLZB 90 500 A2 | 500 | 5 | 1 | 517,700 | 7099 03 8 |
| SLZB 90 600 A2 | 600 | 5 | 1 | 590,900 | 7099 04 0 |
| SLZB 90 700 A2 | 700 | 5 | 1 | 776,800 | 7099 04 2 |
| SLZB 90 800 A2 | 800 | 5 | 1 | 866,000 | 7099 04 4 |
| SLZB 90 900 A2 | 900 | 5 | 1 | 955,200 | 7099 04 6 |
| SLZB 90 1000 A2 | 1000 | 5 | 1 | 1.044,400 | 7099 04 8 |
| SLZB 90 1200 A2 | 1200 | 5 | 1 | 1.222,800 | 7099 05 0 |

V2A Stainless steel, A2

/pc.

Connectors should be ordered separately and in the appropriate quantity.

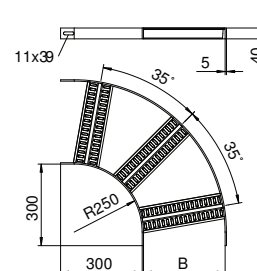

Cable ladder with Z-rung, standard



| Type | Width mm | Rail thickness mm | Pack. m | Weight kg/100 m | Item No. |
|-------------|-------------|-------------------------|------------|--------------------|-----------|
| SLZ 100 A4 | 100 | 5 | 3 | 319,000 | 7098 22 2 |
| SLZ 200 A4 | 200 | 5 | 3 | 372,340 | 7098 22 4 |
| SLZ 300 A4 | 300 | 5 | 3 | 427,670 | 7098 22 6 |
| SLZ 400 A4 | 400 | 5 | 3 | 479,000 | 7098 22 8 |
| SLZ 500 A4 | 500 | 5 | 3 | 532,340 | 7098 23 0 |
| SLZ 600 A4 | 600 | 5 | 3 | 585,670 | 7098 23 2 |
| SLZ 700 A4 | 700 | 5 | 3 | 639,000 | 7098 23 4 |
| SLZ 800 A4 | 800 | 5 | 3 | 692,340 | 7098 23 6 |
| SLZ 900 A4 | 900 | 5 | 3 | 745,670 | 7098 23 8 |
| SLZ 1000 A4 | 1000 | 5 | 3 | 799,000 | 7098 24 0 |
| SLZ 1200 A4 | 1200 | 5 | 3 | 905,340 | 7098 24 2 |

V4A Stainless steel, A4

/m

GB Pickled

Marine cable ladder with perforated side rail of side height 40 mm with welded, perforated Z-rungs. Load tested according to IEC in conjunction with connector, type SLV.

Dimensions

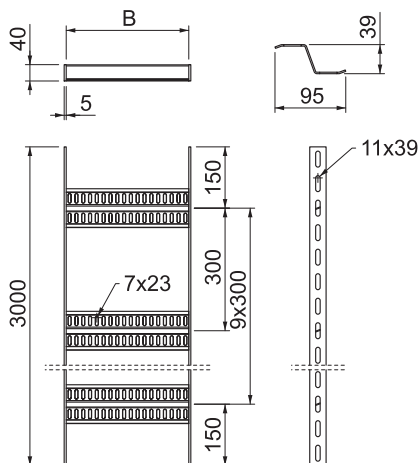

| Type | Length mm | Dimen- sion B mm | Side height mm | Rail thickness mm |
|-------------|--------------|------------------------|----------------------|-------------------------|
| SLZ 100 A4 | 3000 | 110 | 40 | 5 |
| SLZ 200 A4 | 3000 | 210 | 40 | 5 |
| SLZ 300 A4 | 3000 | 310 | 40 | 5 |
| SLZ 400 A4 | 3000 | 410 | 40 | 5 |
| SLZ 500 A4 | 3000 | 510 | 40 | 5 |
| SLZ 600 A4 | 3000 | 610 | 40 | 5 |
| SLZ 700 A4 | 3000 | 710 | 40 | 5 |
| SLZ 800 A4 | 3000 | 810 | 40 | 5 |
| SLZ 900 A4 | 3000 | 910 | 40 | 5 |
| SLZ 1000 A4 | 3000 | 1010 | 40 | 5 |
| SLZ 1200 A4 | 3000 | 1210 | 40 | 5 |

Load

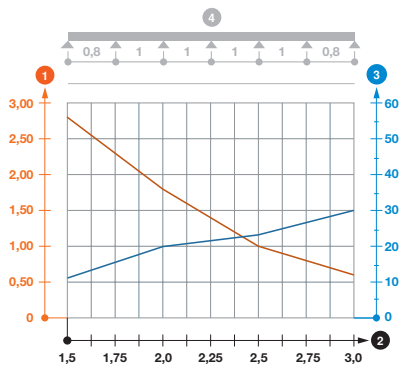

| Type | 1.5 m kN/m | 2.0 m kN/m | 2.5 m kN/m | 3.0 m kN/m |
|-------------|---------------|---------------|---------------|---------------|
| SLZ 100 A4 | 2.8 | 1.75 | 1 | 0.6 |
| SLZ 200 A4 | 2.8 | 1.75 | 1 | 0.6 |
| SLZ 300 A4 | 2.8 | 1.75 | 1 | 0.6 |
| SLZ 400 A4 | 2.8 | 1.75 | 1 | 0.6 |
| SLZ 500 A4 | 2.8 | 1.75 | 1 | 0.6 |
| SLZ 600 A4 | 2.8 | 1.75 | 1 | 0.6 |
| SLZ 700 A4 | 2.8 | 1.75 | 1 | 0.6 |
| SLZ 800 A4 | 2.8 | 1.75 | 1 | 0.6 |
| SLZ 900 A4 | 2.8 | 1.75 | 1 | 0.6 |
| SLZ 1000 A4 | 2.8 | 1.75 | 1 | 0.6 |
| SLZ 1200 A4 | 2.8 | 1.75 | 1 | 0.6 |

1 Permitted cable tray/ladder load in kN/m without man load

2 Support width in m

3 Rail bend in mm at permitted kN/m

— Load curve with cable tray/ladder width in mm

— Strut bend curve according to support width

4 Load scheme during testing

Straight connector

| Type | Pack. pcs | Weight kg/100 pcs. | Item No. |
|------------------|-----------|--------------------|------------------|
| SLV 62 A4 | 10 | 14,600 | 7103 56 8 |

V4A Stainless steel, A4

/pc.

Straight connector as external connector to connect cable ladders and fittings with a side height of 40 mm.

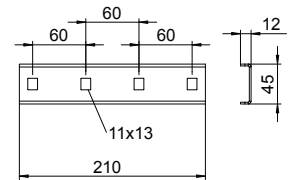

90° bend

| Type | Width rail mm | Material thickness mm | Pack. pcs | Weight kg/100 pcs. | Item No. |
|------------------------|---------------|-----------------------|-----------|--------------------|------------------|
| SLZB 90 100 A4 | 100 | 5 | 1 | 227,900 | 7099 06 0 |
| SLZB 90 200 A4 | 200 | 5 | 1 | 302,100 | 7099 06 2 |
| SLZB 90 300 A4 | 300 | 5 | 1 | 376,200 | 7099 06 4 |
| SLZB 90 400 A4 | 400 | 5 | 1 | 450,200 | 7099 06 6 |
| SLZB 90 500 A4 | 500 | 5 | 1 | 524,300 | 7099 06 8 |
| SLZB 90 600 A4 | 600 | 5 | 1 | 598,300 | 7099 07 0 |
| SLZB 90 700 A4 | 700 | 5 | 1 | 786,600 | 7099 07 2 |
| SLZB 90 800 A4 | 800 | 5 | 1 | 877,000 | 7099 07 4 |
| SLZB 90 900 A4 | 900 | 5 | 1 | 967,300 | 7099 07 6 |
| SLZB 90 1000 A4 | 1000 | 5 | 1 | 1.057,600 | 7099 07 8 |
| SLZB 90 1200 A4 | 1200 | 5 | 1 | 1.238,300 | 7099 08 0 |

V4A Stainless steel, A4

/pc.

Connectors should be ordered separately and in the appropriate quantity.

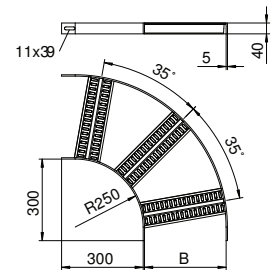

Cable ladder with Z-rung, standard



| Type | Width mm | Rail thickness mm | Available from | Pack. m | Weight kg/100 m | Item No. |
|--------------|-------------|-------------------------|-------------------|------------|--------------------|-----------|
| SLZ 100 ALU | 100 | 5 | 01/2017 | 3 | 106,600 | 7099 77 2 |
| SLZ 200 ALU | 200 | 5 | 01/2017 | 3 | 124,670 | 7099 77 4 |
| SLZ 300 ALU | 300 | 5 | 01/2017 | 3 | 142,740 | 7099 77 6 |
| SLZ 400 ALU | 400 | 5 | 01/2017 | 3 | 160,770 | 7099 77 8 |
| SLZ 500 ALU | 500 | 5 | 01/2017 | 3 | 178,840 | 7099 78 0 |
| SLZ 600 ALU | 600 | 5 | 01/2017 | 3 | 196,900 | 7099 78 2 |
| SLZ 700 ALU | 700 | 5 | 01/2017 | 3 | 214,970 | 7099 78 4 |
| SLZ 800 ALU | 800 | 5 | 01/2017 | 3 | 233,040 | 7099 78 6 |
| SLZ 900 ALU | 900 | 5 | 01/2017 | 3 | 251,100 | 7099 78 8 |
| SLZ 1000 ALU | 1000 | 5 | 01/2017 | 3 | 269,170 | 7099 79 0 |
| SLZ 1200 ALU | 1200 | 5 | 01/2017 | 3 | 305,270 | 7099 79 2 |

Alu Aluminium

/m

Marine cable ladder with perforated side rail of side height 40 mm with welded, perforated Z-rungs.

Dimensions

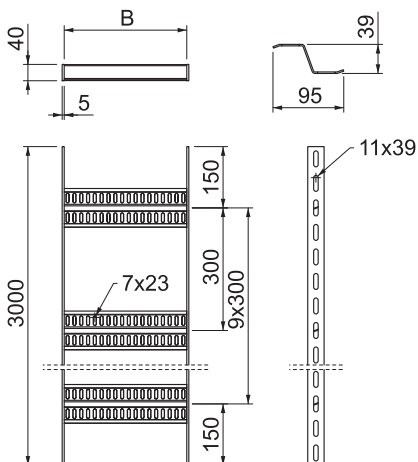

| Type | Length mm | Dimen- sion B mm | Side height mm | Rail thickness mm |
|--------------|--------------|------------------------|----------------------|-------------------------|
| SLZ 100 ALU | 3000 | 110 | 40 | 5 |
| SLZ 200 ALU | 3000 | 210 | 40 | 5 |
| SLZ 300 ALU | 3000 | 310 | 40 | 5 |
| SLZ 400 ALU | 3000 | 410 | 40 | 5 |
| SLZ 500 ALU | 3000 | 510 | 40 | 5 |
| SLZ 600 ALU | 3000 | 610 | 40 | 5 |
| SLZ 700 ALU | 3000 | 710 | 40 | 5 |
| SLZ 800 ALU | 3000 | 810 | 40 | 5 |
| SLZ 900 ALU | 3000 | 910 | 40 | 5 |
| SLZ 1000 ALU | 3000 | 1010 | 40 | 5 |
| SLZ 1200 ALU | 3000 | 1210 | 40 | 5 |

Straight connector



| Type | Available from | Available from | Pack. pcs | Weight kg/100 pcs. | Item No. |
|------------|-------------------|-------------------|--------------|-----------------------|-----------|
| SLV 62 ALU | | 01/2017 | 1 | 12,500 | 7103 55 4 |

Alu Aluminium

/pc.

Straight connector as external connector to connect cable ladders and fittings with a side height of 40 mm.

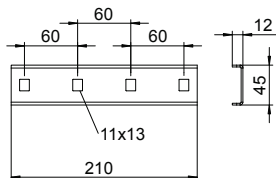

90° bend

| Type | Width mm | Material thickness rail mm | Available from | Pack. pcs | Weight kg/100 pcs. | Item No. |
|------------------|-------------|-------------------------------------|-------------------|--------------|-----------------------|-----------|
| SLZB 90 100 ALU | 100 | 5 | 01/2017 | 1 | 75,800 | 7099 09 0 |
| SLZB 90 200 ALU | 200 | 5 | 01/2017 | 1 | 100,400 | 7099 09 2 |
| SLZB 90 300 ALU | 300 | 5 | 01/2017 | 1 | 125,100 | 7099 09 4 |
| SLZB 90 400 ALU | 400 | 5 | 01/2017 | 1 | 149,700 | 7099 09 6 |
| SLZB 90 500 ALU | 500 | 5 | 01/2017 | 1 | 174,300 | 7099 09 8 |
| SLZB 90 600 ALU | 600 | 5 | 01/2017 | 1 | 198,900 | 7099 10 0 |
| SLZB 90 700 ALU | 700 | 5 | 01/2017 | 1 | 261,600 | 7099 10 2 |
| SLZB 90 800 ALU | 800 | 5 | 01/2017 | 1 | 291,600 | 7099 10 4 |
| SLZB 90 900 ALU | 900 | 5 | 01/2017 | 1 | 321,600 | 7099 10 6 |
| SLZB 90 1000 ALU | 1000 | 5 | 01/2017 | 1 | 351,700 | 7099 10 8 |
| SLZB 90 1200 ALU | 1200 | 5 | 01/2017 | 1 | 411,700 | 7099 11 0 |

Alu Aluminium

/pc.

Connectors should be ordered separately and in the appropriate quantity.

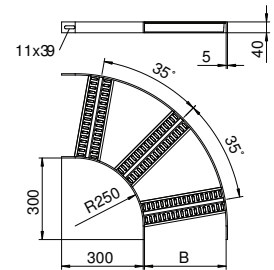

Construction and suspension profile, SL42

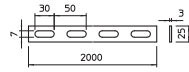

| Type | Dimension mm | Length mm | Pack. m | Weight kg/100 m | Item No. |
|----------------|-----------------|--------------|------------|--------------------|-----------|
| SLH 42 2000 SG | 25x3 | 2000 | 2 | 50,000 | 7103 60 3 |
| SLH 42 2000 FT | 25x3 | 2000 | 2 | 51,500 | 7103 61 1 |
| SLH 42 2000 A2 | 25x3 | 2000 | 2 | 50,000 | 7103 62 0 |
| SLH 42 2000 A4 | 25x3 | 2000 | 2 | 50,000 | 7103 62 6 |

St Steel V2A Stainless steel, A2 V4A Stainless steel, A4 /m

SG welding primed FT Hot-dip galvanised

Perforated side rail profile of ship ladder, SL 42, for creation of suspension and support structures.

The profile is available in bright steel on request.

Construction and suspension profile, SL62

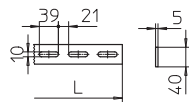

| Type | Dimension mm | Length mm | Pack. m | Weight kg/100 m | Item No. |
|----------------|-----------------|--------------|------------|--------------------|-----------|
| SLH 62 3000 SG | 40x5 | 3000 | 3 | 133,000 | 7103 63 5 |
| SLH 62 3000 FT | 40x5 | 3000 | 3 | 135,700 | 7103 64 3 |
| SLH 62 3000 A2 | 40x5 | 3000 | 3 | 133,000 | 7103 65 0 |
| SLH 62 3000 A4 | 40x5 | 3000 | 3 | 133,000 | 7103 65 6 |

St Steel V2A Stainless steel, A2 V4A Stainless steel, A4 /m

SG welding primed FT Hot-dip galvanised

Perforated side rail of ship cable ladder, SL 62, for creation of suspension and support structures.

The profile is available in bright steel on request.

Construction and suspension profile

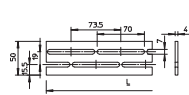

| Type | Dimension mm | Length mm | Pack. m | Weight kg/100 m | Item No. |
|----------------|-----------------|--------------|------------|--------------------|-----------|
| FESP L 50 4 BK | 50x4 | 3000 | 3 | 117,000 | 7104 96 0 |
| FESP L 50 4 FT | 50x4 | 3000 | 3 | 120,000 | 7105 00 2 |

St Steel /m

BK Bright FT Hot-dip galvanised

Flat iron profile with double, offset longitudinal hole row for creation of suspensions and support structures.

Construction and suspension profile

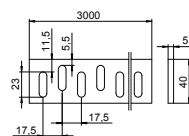

| Type | Dimension mm | Length mm | Pack. m | Weight kg/100 m | Item No. |
|----------------|-----------------|--------------|------------|--------------------|-----------|
| FESP Q 40 5 SG | 40x5 | 3000 | 3 | 127,000 | 7104 35 8 |
| FESP Q 40 5 FT | 40x5 | 3000 | 3 | 130,000 | 7104 35 6 |

St Steel /m

SG welding primed FT Hot-dip galvanised

Flat iron profile with double, side-offset slot row to create suspensions and support constructions.

Construction and suspension profile

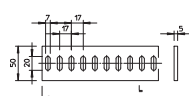

| Type | Dimension mm | Length mm | Pack. m | Weight kg/100 m | Item No. |
|----------------|-----------------|--------------|------------|--------------------|-----------|
| FESP Q 50 5 BK | 50x5 | 3000 | 3 | 162,200 | 7104 36 7 |

St Steel /m

BK Bright

Flat iron profile with slots to create suspensions and support constructions.

Construction and suspension profile

| Type | Length mm | Plate | | Pack. Weight | | Item No. |
|-----------------------|--------------|-------|-----------------|--------------|----------|------------------|
| | | mm | thickness mm | m | kg/100 m | |
| FESP Q 50 4 BK | 3000 | | 4 | 3 | 126,600 | 7104 66 9 |

- St** Steel
- BK** Bright

/m

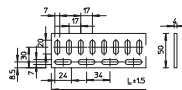

Flat iron profile with transverse and longitudinal perforation to create suspensions and support constructions.

Angle profile

| Type | Length mm | Plate | | Pack. Weight | | Item No. |
|----------------------|--------------|-------|-----------------|--------------|----------|------------------|
| | | mm | thickness mm | m | kg/100 m | |
| WESP 50 20 BK | 3000 | | 4 | 3 | 159,000 | 7105 66 5 |

- St** Steel
- BK** Bright

/m

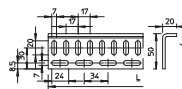

Angle profile with transverse and longitudinal perforation to create suspension and support constructions.

Angle profile

| Type | Length mm | Pack. Weight | | Item No. |
|----------------------|--------------|--------------|----------|------------------|
| | | m | kg/100 m | |
| WESP 50 40 SG | 3000 | 3 | 239,340 | 7105 67 5 |
| WESP 50 40 FT | 3000 | 3 | 246,340 | 7105 67 3 |

- St** Steel
- SG** welding primed **FT** Hot-dip galvanised

/m

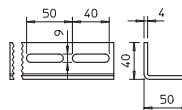

Angle profile with longitudinal perforation row to create suspension and support constructions.

Angle profile

| Type | Length mm | Plate | | Pack. Weight | | Item No. |
|----------------------|--------------|-------|-----------------|--------------|----------|------------------|
| | | mm | thickness mm | m | kg/100 m | |
| WESP 60 15 BK | 3000 | | 4 | 3 | 179,000 | 7105 96 7 |

- St** Steel
- BK** Bright

/m

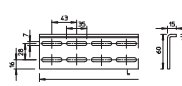

Angle profile with longitudinal perforation to create suspension and support constructions.

Welding angle

| Type | Dimension mm | Pack. Weight | | Item No. |
|---------------|-----------------|--------------|-------------|------------------|
| | | pcs | kg/100 pcs. | |
| ASW FT | 25x50 | 10 | 5,700 | 6015 35 0 |

- St** Steel
- FT** Hot-dip galvanised

/pc.

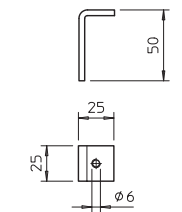

Connection bracket for mounting marine cable ladders and marine trays, for welding to steel structures.

Truss-head bolt with nut and washer

| Type | Dimension mm | Pack. Weight | | Item No. |
|---------------------|-----------------|--------------|-------------|------------------|
| | | pcs | kg/100 pcs. | |
| FRS 8x25 F | M8 x 25 | 50 | 2,300 | 6406 99 8 |
| FRS 10x30 F | M10 x 30 | 50 | 5,000 | 6407 57 9 |
| FRS 8x25 A2 | M8 x 25 | 50 | 2,300 | 6406 81 5 |
| FRS 10x30 A2 | M10 x 30 | 50 | 4,500 | 6406 72 6 |

- St** Steel **V2A** Stainless steel, A2
- F** Hot-dip galvanised

/100 pc.

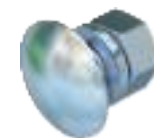
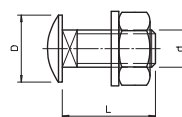

Truss-head bolt with square neck. With washer and hexagonal nut.

Hook screw

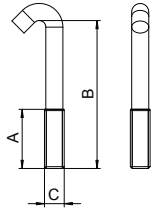

| Type | Thread | Pack. pcs | Weight kg/100 pcs. | Item No. |
|-------------|--------|-----------|--------------------|-----------|
| HS M6x45 A4 | M6 | 25 | 0,970 | 1154 97 0 |
| HS M8x60 A4 | M8 | 25 | 2,330 | 1154 97 5 |

V4A Stainless steel, A4 /100 pc.

Hook screw for fastening cable tracks on the bracket.

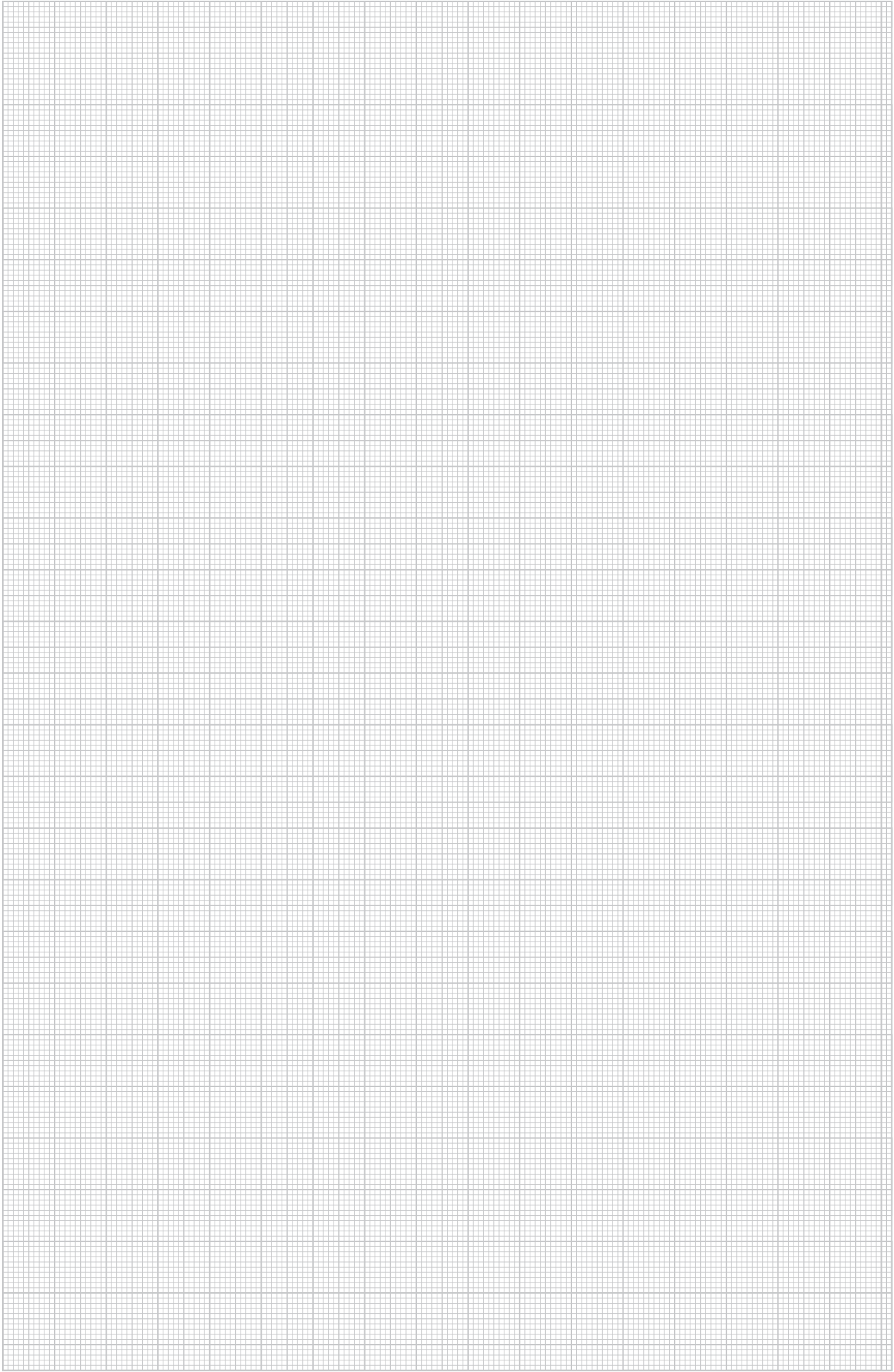

Tightening strap



| Type | Dimension mm | Minimum breaking load kN | Colour | Pack. m | Weight kg/100 m | Item No. |
|----------------------------|-----------------|-----------------------------------|------------|------------|--------------------|------------------|
| 574 G STGR | 17 x 1,2 | 1.35 | Stone grey | 25 | 5,880 | 6490 01 8 |
| St Steel | | | | | | price/100 m |
| G Electrogalvanised | | | | | | |

Galvanised tightening strap and with plastic covering for fastening on cable trays and ladders.

Dimensions

Dimensions

| Type | B | t | B1 | t1 |
|-------------------|----|-----|------|-----|
| | mm | mm | mm | mm |
| 574 G STGR | 17 | 1.2 | 15.5 | 0.3 |

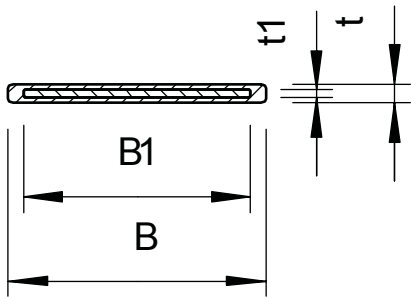

Tightening strap lock

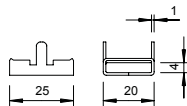

| Type | Shipping box pcs | Pack. pcs | Weight kg/100 pcs. | Item No. |
|---|------------------------|--------------|-----------------------|------------------|
| 192 DD | 1200 | 100 | 0,900 | 6490 90 5 |
| St Steel | | | | /100 pc. |
| DD Strip galvanised zinc/aluminium, Double Dip | | | | |

Tightening strap lock for mounting under deck.

Tightening strap

| Type | Dimension mm | Length mm | Minimum breaking load kN | Colour | Pack. pcs | Weight kg/100 pcs. | Item No. |
|-----------------------|-----------------|--------------|-----------------------------------|------------|--------------|-----------------------|------------------|
| 574 03 45 STGR | 17 x 1,2 | 450 | 1.35 | Stone grey | 25 | 3,260 | 6490 12 5 |

St Steel /100 pc.
G Electrogalvanised

Tightening strap, 574, electrogalvanised, completely pre-assembled with tightening strap lock.



Dimensions

| Type | B | t | B1 | t1 |
|-----------------------|----|-----|------|-----|
| | mm | mm | mm | mm |
| 574 03 45 STGR | 17 | 1.2 | 15.5 | 0.3 |

Dimensions

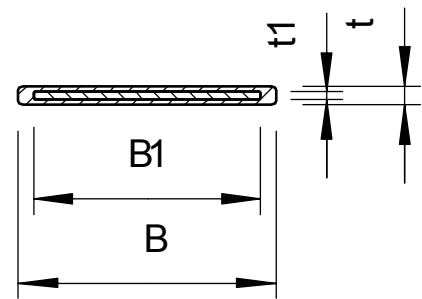

Tightening strap



| Type | Dimension mm | Minimum breaking load kN | Colour | Pack. m | Weight kg/100 m | Item No. |
|------------|--------------|--------------------------|--------------|---------|-----------------|-----------|
| 574 03 SW | 17 x 1,2 | 2.25 | Jet black | 25 | 6,950 | 6490 02 6 |
| 574 03 LBL | 17 x 1,2 | 2.25 | Light blue | 25 | 6,950 | 6490 03 4 |
| 574 05 PGN | 17 x 1,2 | 3.5 | Patina green | 25 | 7,120 | 6490 05 0 |

V2A Stainless steel, A2

price/100 m

Tightening strap made of rustproof steel and with plastic covering for fastening on cable trays and ladders.

Dimensions

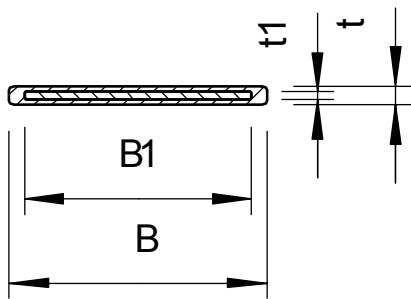

Dimensions

| Type | B mm | t mm | B1 mm | t1 mm |
|------------|------|------|-------|-------|
| 574 03 SW | 17 | 1.2 | 15.5 | 0.3 |
| 574 03 LBL | 17 | 1.2 | 15.5 | 0.3 |
| 574 05 PGN | 17 | 1.2 | 14.5 | 0.5 |

Tightening strap lock

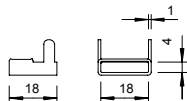

| Type | Shipping box pcs | Pack. pcs | Weight kg/100 pcs. | Item No. |
|--------|------------------|-----------|--------------------|-----------|
| 197 A2 | 1800 | 100 | 0,600 | 6490 96 4 |
| 197 A4 | 1800 | 100 | 0,600 | 6490 97 2 |

V2A Stainless steel, A2 V4A Stainless steel, A4

/100 pc.

Tightening strap lock for single-sided locking of tightening strap in areas with high corrosion requirements.

Tightening strap

| Type | Dimension mm | Length mm | Minimum breaking load kN | Colour | Pack. pcs | Weight kg/100 pcs. | Item No. |
|---------------|-----------------|--------------|-----------------------------------|--------------|--------------|-----------------------|-----------|
| 574 03 30 SW | 17 x 1,2 | 300 | 2.25 | Jet black | 25 | 2,410 | 6490 11 1 |
| 574 03 30 LBL | 17 x 1,2 | 300 | 2.25 | Light blue | 25 | 2,410 | 6490 10 7 |
| 574 03 45 LBL | 17 x 1,2 | 450 | 2.25 | Light blue | 25 | 3,260 | 6490 12 3 |
| 574 05 55 PGN | 17 x 1,2 | 550 | 3.5 | Patina green | 25 | 4,660 | 6490 15 8 |
| 574 05 65 PGN | 17 x 1,2 | 650 | 3.5 | Patina green | 25 | 5,370 | 6490 17 4 |

V2A Stainless steel, A2

/100 pc.

Tightening strap, 574, completely pre-assembled with tightening strap lock.



Dimensions

| Type | B | t | B1 | t1 |
|---------------|----|-----|------|-----|
| | mm | mm | mm | mm |
| 574 03 30 SW | 17 | 1.2 | 15.5 | 0.3 |
| 574 03 30 LBL | 17 | 1.2 | 15.5 | 0.3 |
| 574 03 45 LBL | 17 | 1.2 | 15.5 | 0.3 |
| 574 05 55 PGN | 17 | 1.2 | 14.5 | 0.5 |
| 574 05 65 PGN | 17 | 1.2 | 14.5 | 0.5 |

Dimensions

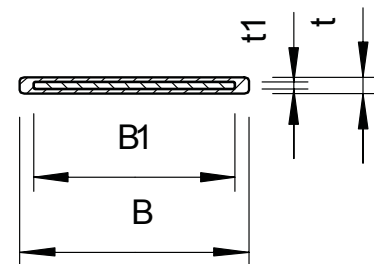

Collet

| Type | Pack. pcs | Weight kg/100 pcs. | Item No. |
|------|--------------|-----------------------|-----------|
| 575 | 1 | 29,700 | 6498 01 9 |

St Steel

/pc.

Tightening tool for OBO tightening straps of type 574 in conjunction with locks of type 192 and 197. Simple collet without ratchet function and cutting. With ergonomically shaped handles.



Collet

| Type | Pack. pcs | Weight kg/100 pcs. | Item No. |
|------|--------------|-----------------------|-----------|
| 576 | 1 | 132,000 | 6498 02 7 |

St Steel

/pc.

Tightening tool for OBO tightening straps of type 574 in conjunction with locks of type 192 and 197. With high clamping force, ratchet function, cutting and round handles for comfortable handling.



Easy to use – professional result

Sealing compound system PYROLIQ®

In shipbuilding cable and pipe penetrations in decks and bulkheads must be sealed to meet the high demands on water and gas tightness and the fire resistance.

Here the sealing compound system PYROLIQ® is used: with existing on-site materials the framework for the sealing will be created and after the installation of cables and pipes with a few hand's touch filled with the components of the PYROLIQ® system. The sealings are up to 60 minutes fire-resistant, watertight to a pressure of 2.5 bar and gas-tight to 30 mbar.

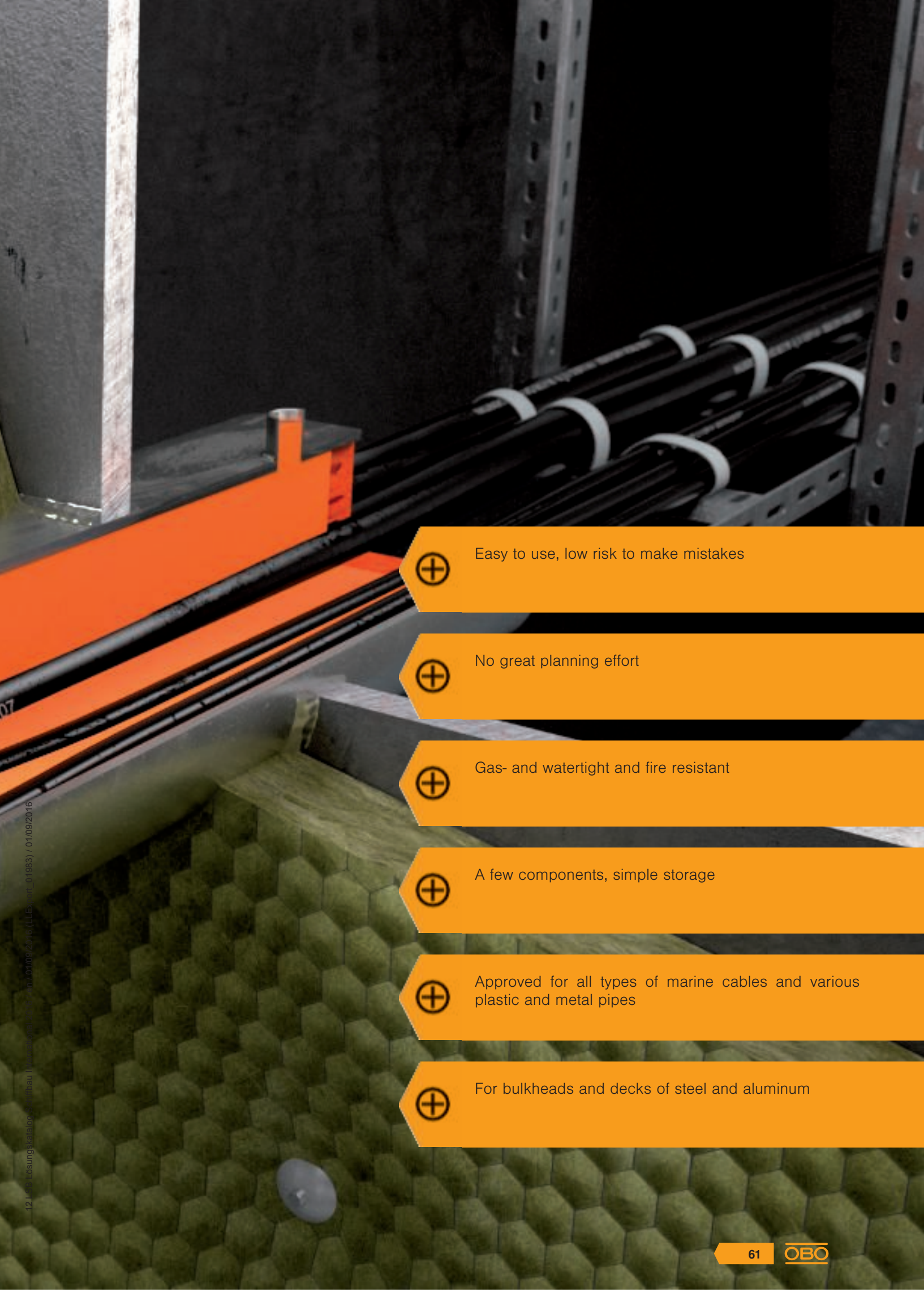

Easy to use, low risk to make mistakes



No great planning effort



Gas- and watertight and fire resistant



A few components, simple storage



Approved for all types of marine cables and various plastic and metal pipes



For bulkheads and decks of steel and aluminum

Sealing compound



| Type | Contents kg | Pack. Weight | | Item No. |
|----------|----------------|--------------|-------------|-----------|
| | | pcs | kg/100 pcs. | |
| VMS-TE 1 | 2.5 | 1 | 250,000 | 7203 84 0 |
| VMS-TE 2 | 12.5 | 1 | 1.250,000 | 7203 84 3 |

Special mortar /pc.
 Dry compound in plastic container to mix with tap water. Makes a gas-tight and watertight seal of fire resistance class A-60 to IMO resolution A.754(18). Including measuring cup.
 The mixing ratio of water to powder is 1:2. The mixed compound is pumpable for approx. 45 minutes. The mixture is chemically hardened after 72 hours.
 Stored in a dry and frost-free environment, the dry compound will keep for 3 years.

Expanding module, small



| Type | Dimension mm | Pack. Weight | | Item No. |
|-----------|-----------------|--------------|-------------|-----------|
| | | pcs | kg/100 pcs. | |
| VMS-QMK 1 | 120x25x6 | 20 | 0,600 | 7203 84 6 |

Foam /pc.
 Expanding foam modules to replace a casing in the sealing compound system if part of the casing has been lost. The modules expand by the factor 10 when sprinkled with the impregnating fluid, closing gaps and joints between the cables installed.
 After the cables have been impregnated they are hardly flammable, fire-retardant and self-extinguishing.
 Stored in a dry environment, the expanding modules have an unlimited lifespan.

Expanding module, large



| Type | Dimension mm | Pack. Weight | | Item No. |
|-----------|-----------------|--------------|-------------|-----------|
| | | pcs | kg/100 pcs. | |
| VMS-QMG 1 | 800x25x6 | 15 | 5,200 | 7203 84 9 |

Foam /pc.
 Expanding foam modules to replace a casing in the sealing compound system if part of the casing has been lost. The modules expand by the factor 10 when sprinkled with the impregnating fluid, closing gaps and joints between the cables installed.
 After the cables have been impregnated they are hardly flammable, fire-retardant and self-extinguishing.
 Stored in a dry environment, the expanding modules have an unlimited lifespan.

Impregnation fluid



| Type | Contents ml | Pack. Weight | | Item No. |
|----------|----------------|--------------|-------------|-----------|
| | | pcs | kg/100 pcs. | |
| VMS-IF 1 | 1000 | 1 | 104,500 | 7203 85 2 |

/pc.
 Fluid to sprinkle the expanding module.
 When 5 long expanding modules are used, approx. 1 l impregnation fluid is required.
 Stored in a frost-free environment it has a lifespan of 2 years.

Sealing compound for external use



| Type | Contents kg | Pack. Weight | | Item No. |
|----------|----------------|--------------|-------------|-----------|
| | | pcs | kg/100 pcs. | |
| VMS-VA 1 | 1 | 1 | 100,000 | 7203 85 8 |

Special mortar /pc.
 Flame-retardant sealing compound for insulations in sealing compound systems. Watertight and against common technical oils as well as weak/diluted acids resistant. Halogen-free and cold-hardening.
 2 components (hardener and resin) in tin with lid to push through. Lifespan of 12 months in original and closed packaging at temperature between +10 and +40 °C.

Sealing compound, water-repellent

| Type | Contents kg | Pack. Weight | | Item No. |
|-----------------|----------------|--------------|-------------|------------------|
| | | pcs | kg/100 pcs. | |
| VMS-VW 1 | 1 | 1 | 100,000 | 7203 86 4 |

Special mortar /pc.

Flame-retardant sealing compound for insulations in sealing compound systems for the application in water-filled openings.

Watertight and against common technical oils as well as weak/diluted acids resistant. Halogen-free and cold-hardening.

2 components (hardener and resin) in tin with lid to push through. Lifespan of 6 months in original and closed packaging at temperature between +10 and +40 °C.



Sealing compound, conductive

| Type | Contents kg | Pack. Weight | | Item No. |
|-----------------|----------------|--------------|-------------|------------------|
| | | pcs | kg/100 pcs. | |
| VMS-VL 1 | 1 | 1 | 100,000 | 7203 86 7 |

Special mortar /pc.

Electrically conductive sealing compound for insulations in sealing compound systems and for the integration of the woven cable shield in EMV compliant installations. 2 components (hardener and resin) in tin with lid to push through. Lifespan of 6 months when stored in frost-free storage.



Pipe insulating strip

| Type | Dimension mm | Pack. Weight | | Item No. |
|---------------|-----------------|--------------|-------------|------------------|
| | | pcs | kg/100 pcs. | |
| VMS-RS | 1000 x 100 x 3 | 3 | 47,000 | 7203 87 0 |

Intumescent material /pc.

Insulation forming strip for the application in sealing compound system when feeding through flammable pipes.

Please protect against sunlight. When stored in a dry environment it has an unlimited lifespan.



Identification plate

| Type | Language | Pack. Weight | | Item No. |
|------------------|----------|--------------|-------------|------------------|
| | | pcs | kg/100 pcs. | |
| VMS-KS DE | German | 1 | 2,400 | 7203 87 4 |
| VMS-KS EN | English | 1 | 2,400 | 7203 87 8 |
| VMS-KS IT | — | 1 | 2,400 | 7203 87 6 |

PVC Polyvinylchloride /pc. /pc.

Identification plate to self-labelling the insulation of the sealing compound system to the IMO A.754(18) with a waterproof and lightproof felt tip pen.

Including 2 cable ties for fastening onto the cable or onto the cable tray system in the area of the insulation.



OBO Bettermann GmbH & Co. KG

PO Box 1120
58694 Menden

Customer Service Germany

Tel. +49 (0)2373 89-1700
Fax +49 (0)2373 89-1238
E-mail: export@obo.de

www.obo-bettermann.com

Building Connections

